

PART NO:	9910/9920 POST BED MACHINE			
A1055-0A				
J1041				
J1051	A. BM-9910 · BM-9920 本体机构 ARM BED AND IT'S ACCESSORIES			
J1052				
J1063				
J1077				
J436C				
J4365				
T101C				
T101:				
T303C				
ZMBC				
ZMBC				
ZMBC				
ZMBC				
ZMBC				
ZMBC				
ZMBC				
ZMCC				
ZMHC				

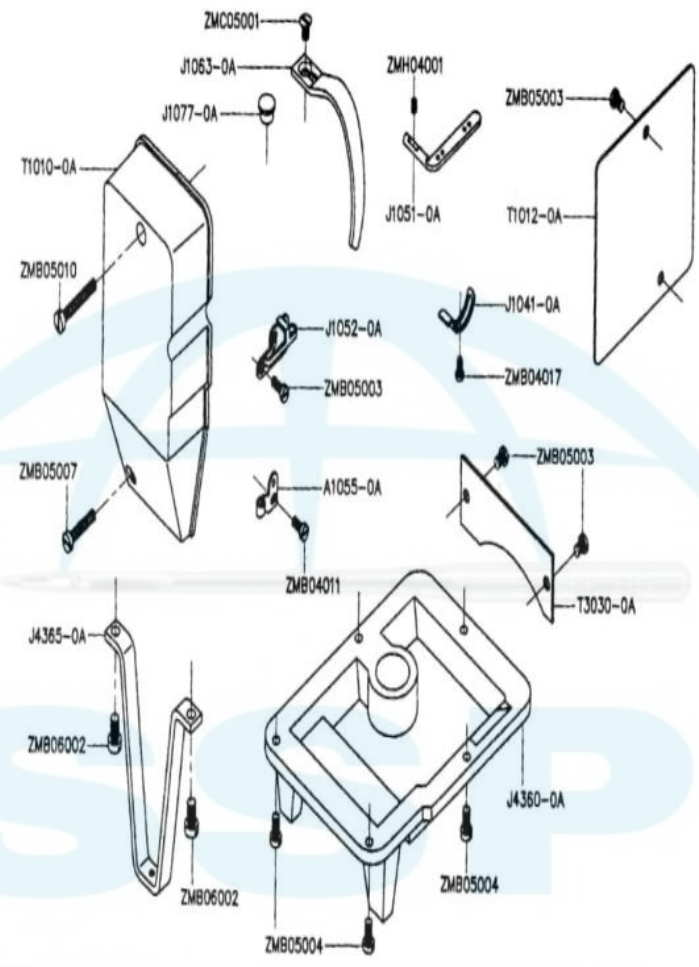
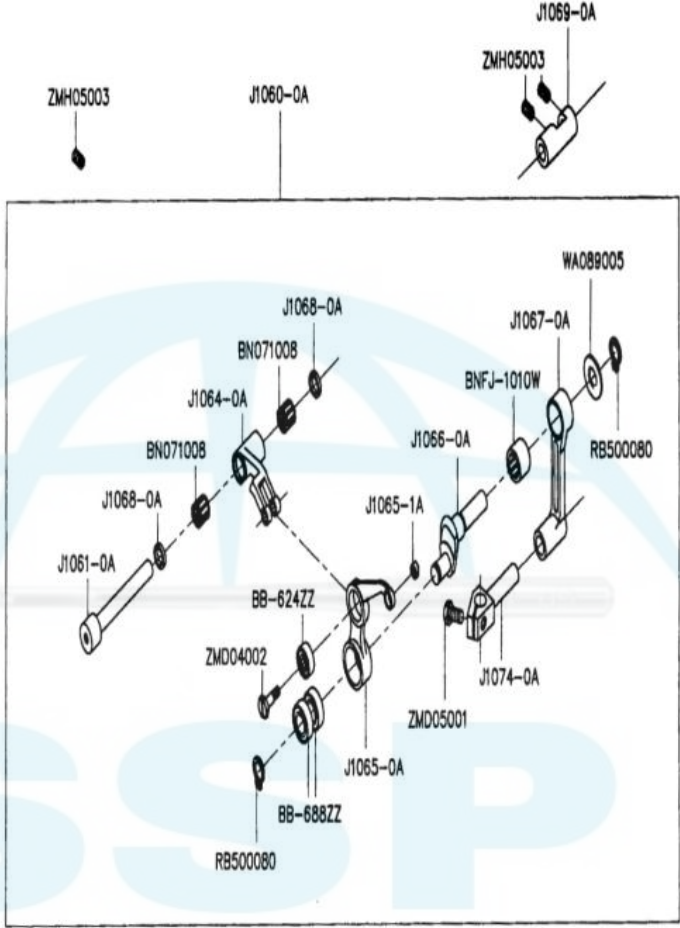

PART NO:	9910/9920 POST BED MACHINE		
A1021-0A	<p>B. BM-9910 · BM-9920 缝线压力调整机构 UPPER THREAD TENSION REGULATOR MECHANISM</p>		
A1024-1A			
A1026-1A			
A1027-1A			
A1028-1A			
A1028-2A			
A1030-0A			
A1031-0A			
A1032-0A			
A1033-0A			
A1034-0A			
A1035-0A			
A1036-0A			
A1038-0A			
B1027-0A			
J1026-0A			
J1026-3A			
T1020-0A			
T1020-1A			
T1037-0A			
T1043-0B			
ZMB04011			
ZMB04022			
ZMNO6001			
ZSB06001			
ZSB06003			
ZSG09004			
ZSG09005			
ZSL09001			
ZSN16002			

PART NO:	9910/9920 POST BED MACHINE					
BB-688ZZ	<div style="display: flex; justify-content: space-around;"> <div style="text-align: center;"> <p>D. BM-9910 · BM-9920 轮钱组机构 ROLLER PRESSER FOOT MECHANISM</p> <p>J1213-0A(小small)</p> </div> <div style="text-align: center;"> <p>J1213-1A(大large)</p> </div> <div style="text-align: center;"> <p>J1213-3A(中middle)</p> </div> </div>					
J1213-0A						
J1213-1A						
J1213-3A						
J1510-0A						
J1510-1A						
J1510-3A						
J1511-0A						
J1511-1A						
J1511-3A						
J1512-0A						
J1513-0A						
J1514-0A						
J1514-1A						
J1515-0A						
J1515-1A						
OBM00020						
RA200160						
RB300080						
RC1000B5						
WA029002						
WA029003						
WA029004						
WA089015						
YA025117						
ZMA02510						
ZMB04035						
ZMC02502						
ZMC02505						

PART NO:	9910/9920 POST BED MACHINE		
BB-624ZZ	<p data-bbox="502 302 1013 331">E. BM-9910 · BM-9920 天秤机构 TAKE-UP LEVER MECHANISM</p> 		
BN071008			
BNFJ-1010W			
J1060-0A			
J1061-0A			
J1064-0A			
J1065-0A			
J1065-1A			
J1066-0A			
J1067-0A			
J1068-0A			
J1069-0A			
J1074-0A			
RB500080			
WA089005			
ZMD04002			
ZMD05001			
ZMH05003			

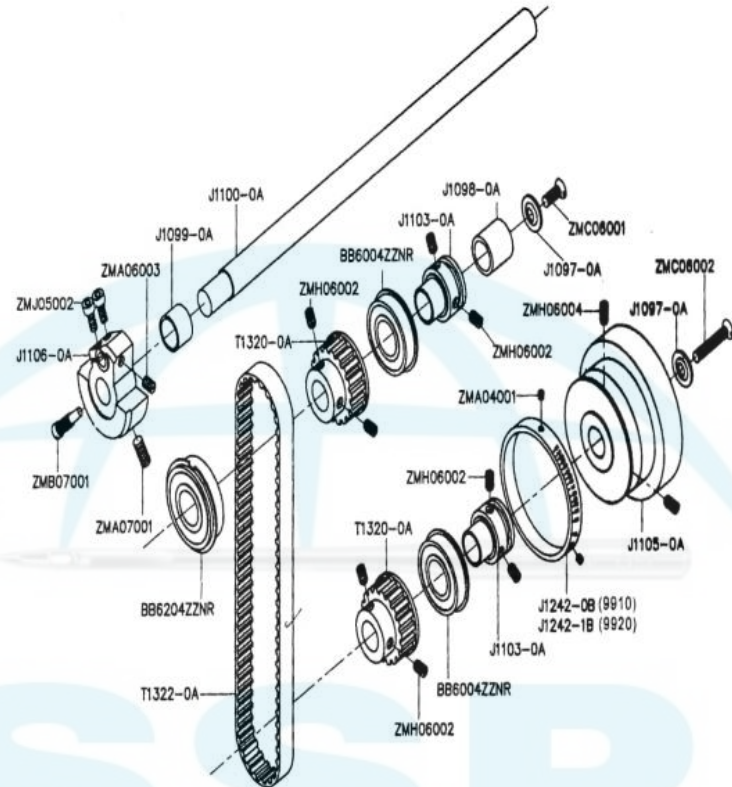
PART NO:	9910/9920 POST BED MACHINE		
BB6004ZZNR	<p>F. BM-9910 · BM-9920 上轴·皮带轮机构 UPPER SHAFT AND BALANCE WHEEL MECHANISM</p> 		
BB6204ZZNR			
J1097-0A			
J1098-0A			
J1099-0A			
J1100-0A			
J1103-0A			
J1105-0A			
J1106-0A			
J1242-0B			
J1242-1B			
T1320-0A			
T1322-0A			
ZMA04001			
ZMA06003			
ZMA07001			
ZMB07001			
ZMC06001			
ZMC06002			
ZMH06002			
ZMH06004			
ZMJ05002			

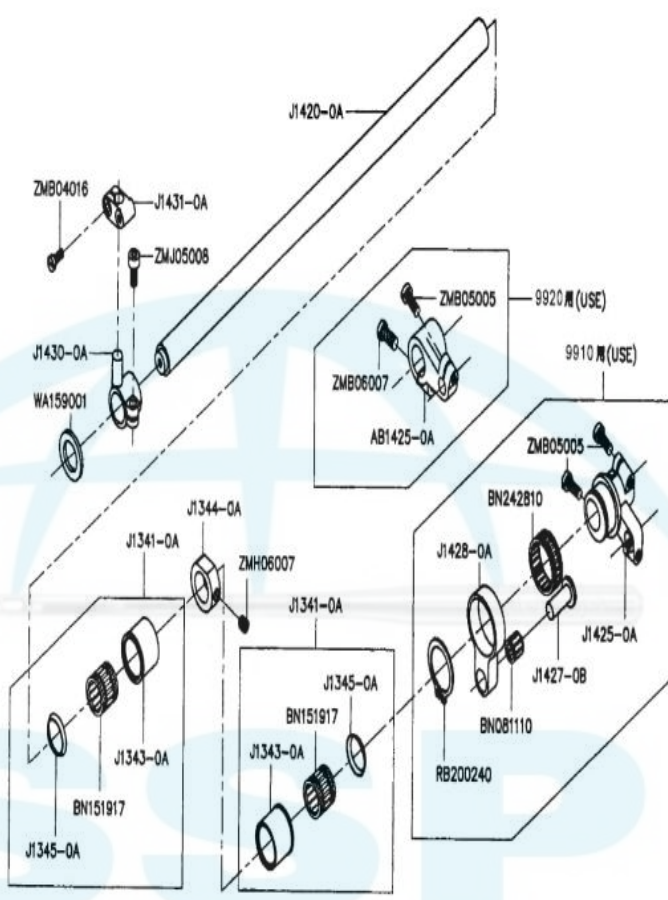
PART NO:	9910/9920 POST BED MACHINE		
AB1425-OA	<p>G. BM-9910 · BM-9920 上边心机构 UPPER SIDE SHAFT MECHANISM</p> 		
BN081110			
BN151917			
BN242810			
J1341-OA			
J1343-OA			
J1344-OA			
J1345-OA			
J1420-OA			
J1425-OA			
J1427-OB			
J1828-OA			
J1430-OA			
J1431-OA			
RB200240			
WA159001			
ZMB04016			
ZMB05005			
ZMB06007			
ZMH06007			
ZMJ05008			

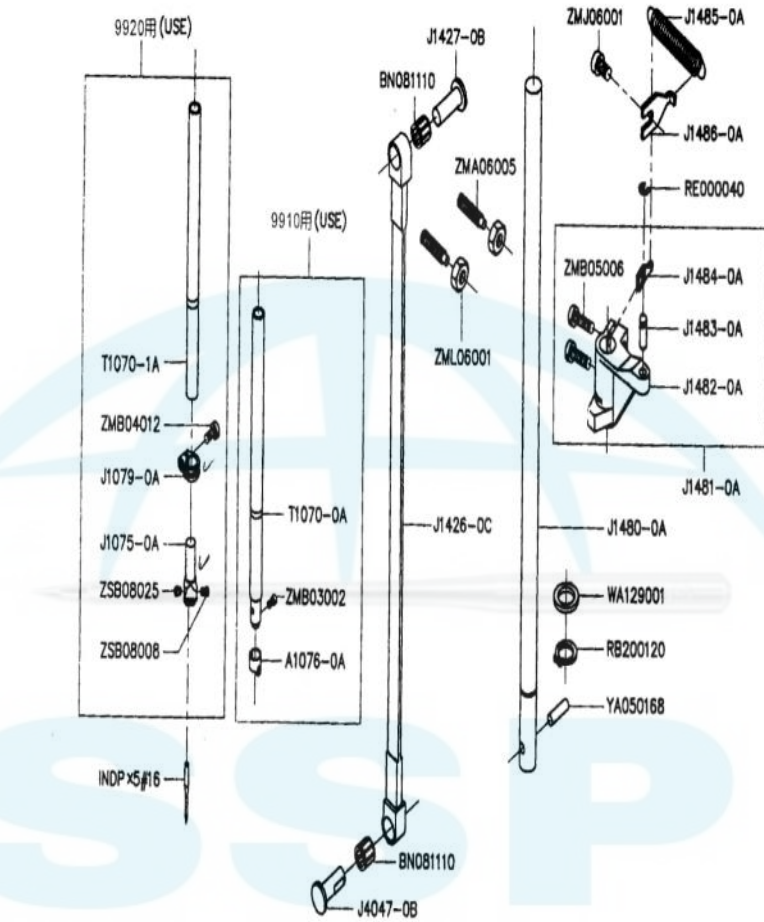
PART NO:	9910/9920 POST BED MACHINE		
A1076-0A	 <p>H. BM-9910 · BM-9920 针棒机构 NEEDLE BAR MECHANISM</p> <p>9920用 (USE) 9910用 (USE)</p> <p>Parts shown include: T1070-1A, ZMB04012, J1079-0A, J1075-0A, ZSB08025, ZSB08008, ZSB08008, ZSB08025, INDP x5 #16, T1070-0A, ZMB03002, A1076-0A, J1427-0B, BNO81110, ZMA06005, ZML06001, J1426-DC, J1480-0A, WA129001, RB200120, YA050168, ZMJ06001, J1485-0A, ZMJ06001, J1485-0A, J1486-0A, RE000040, ZMB05006, J1484-0A, J1483-0A, J1482-0A, J1481-0A, J1481-0A, J1480-0A, WA129001, RB200120, YA050168, BNO81110, J4047-0B.</p>		
BN081110			
INDPX5#16			
J1075-0A			
J1079-0A			
J1426-0A			
J1427-0A			
J1480-0A			
J1481-0A			
J1482-0A			
J1483-0A			
J1484-0A			
J1485-0A			
J1486-0A			
J4047-0B			
RB200120			
RE000040			
T1070-0A			
T1070-1A			
WA129001			
YA050168			
ZMA06005			
ZMB03002			
ZMB04012			
ZMB05006			
ZMJ06001			
ZML06001			
ZSB08008			
ZSB08025			

PART NO:	9910/9920 POST BED MACHINE		
BN15197	<p>I. BM-9910 · BM-9920 针棒摇摆机构 NEEDLE BAR ROCKING MECHANISM</p>		
J1073-0A			
J1081-0A			
J1082-0A			
J1090-0A			
J1093-0A			
J1335-0A			
J1340-0A			
J1341-0A			
J1341-1A			
J1342-0A			
J1342-1A			
J1343-0A			
J1343-1A			
J1344-0A			
J1345-0A			
XB110002			
XB314001			
XB400002			
YB040025			
ZMB04006			
ZMB04029			
ZMB05002			
ZMB05005			
ZMB06003			
ZMH06005			
ZMH06007			

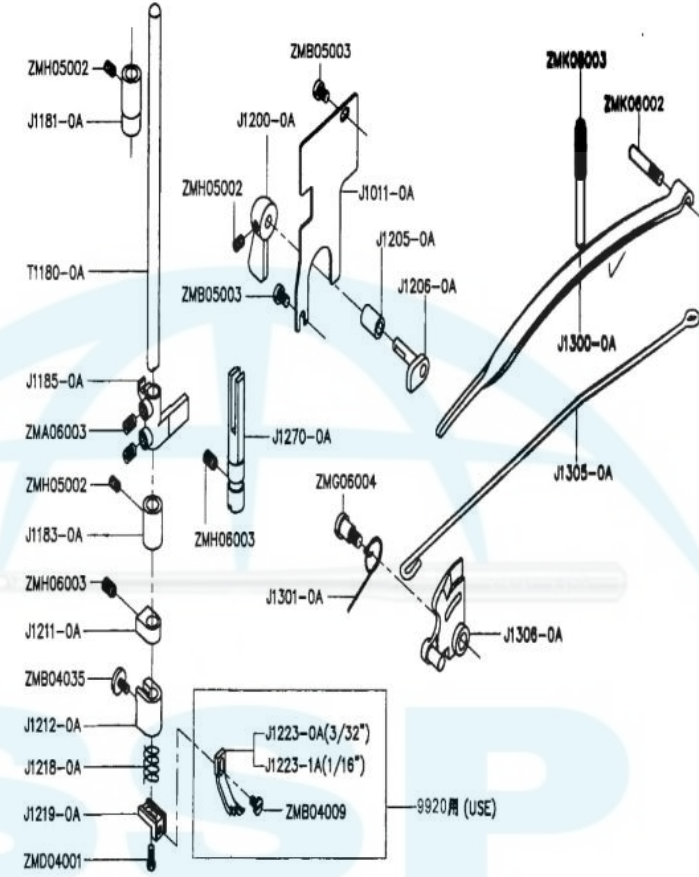
PART NO:	9910/9920 POST BED MACHINE		
J1011-0A	<p style="text-align: center;">J. BM-9910 · BM-9920 押棒机构 PRESSER FOOT BAR MECHANISM</p> 		
J1181-0A			
J1183-0A			
J1185-0A			
J1200-0A			
J1205-0A			
J1206-0A			
J1211-0A			
J1212-0A			
J1218-0A			
J1219-0A			
J1223-0A			
J1223-1A			
J1270-0A			
J1300-0A			
J1301-0A			
J1305-0A			
J1306-0A			
T1180-0A			
ZMA06003			
ZMB04009			
ZMB04035			
ZMB05003			
ZMD04001			
ZMG06004			
ZMH05002			
ZMH06003			
ZMK06002			
ZMK08003			

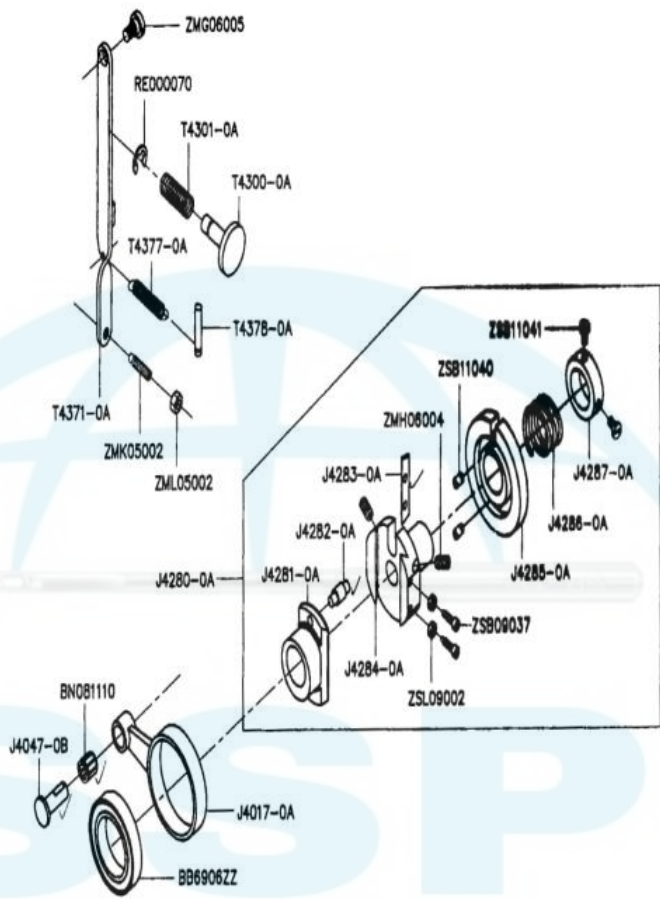
PART NO:	9910/9920 POST BED MACHINE		
BB6906ZZ	<p>L. BM-9910 · BM-9920 缝目调整器机构 STITCH REGULATOR MECHANISM</p> 		
BN081110			
J4017-0A			
J4047-0B			
J4280-0A			
J4281-0A			
J4282-0A			
J4283-0A			
J4284-0A			
J4285-0A			
J4286-0A			
J4287-0A			
RE000070			
T4300-0A			
T4301-0A			
T4371-0A			
T4377-0A			
T4378-0A			
ZMG06005			
ZMH06004			
ZMK05002			
ZML05002			
ZSB09037			
ZSB11040			
ZSB11041			
ZSL09002			

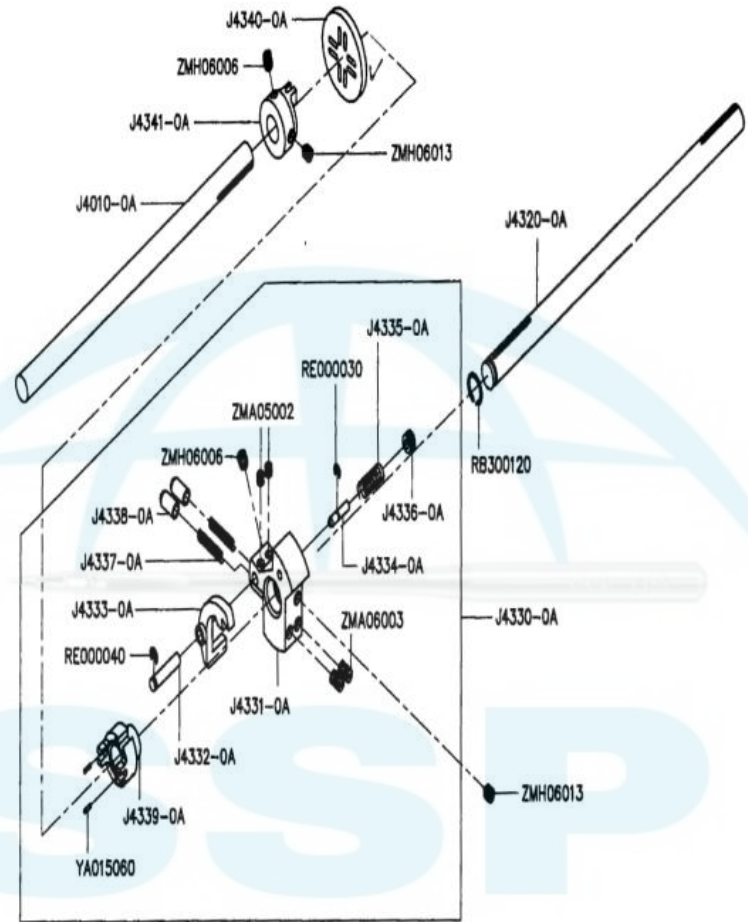
PART NO:	9910/9920 POST BED MACHINE			
J4010-0A	<p data-bbox="414 313 941 347">N. BM-9910 · BM-9920 离合器组机构 CLUTCH SET MECHANISM</p> 			
J4320-0A				
J4330-0A				
J4331-0A				
J4332-0A				
J4333-0A				
J4334-0A				
J4335-0A				
J4336-0A				
J4337-0A				
J4338-0A				
J4339-0A				
J4340-0A				
J4341-0A				
RB300120				
RE000030				
RE000040				
YA015060				
ZMA05002				
ZMA06003				
ZMH06006				
ZMH06013				

PART NO: 9910/9920 POST BED MACHINE

- BB6002ZZ
- J1077-0A
- J4011-0A
- J6001-0A
- J6021-0A
- J6024-0A
- J6036-0A
- J6050-0A
- J6169-0A
- WA059010
- ZMA04003
- ZMA06002
- ZMB06004
- ZMC03001
- ZMC04001
- ZMJ05002
- ZMJ06002

O. BM-9910 中座机构 CENTRAL BRACKET MECHANISM

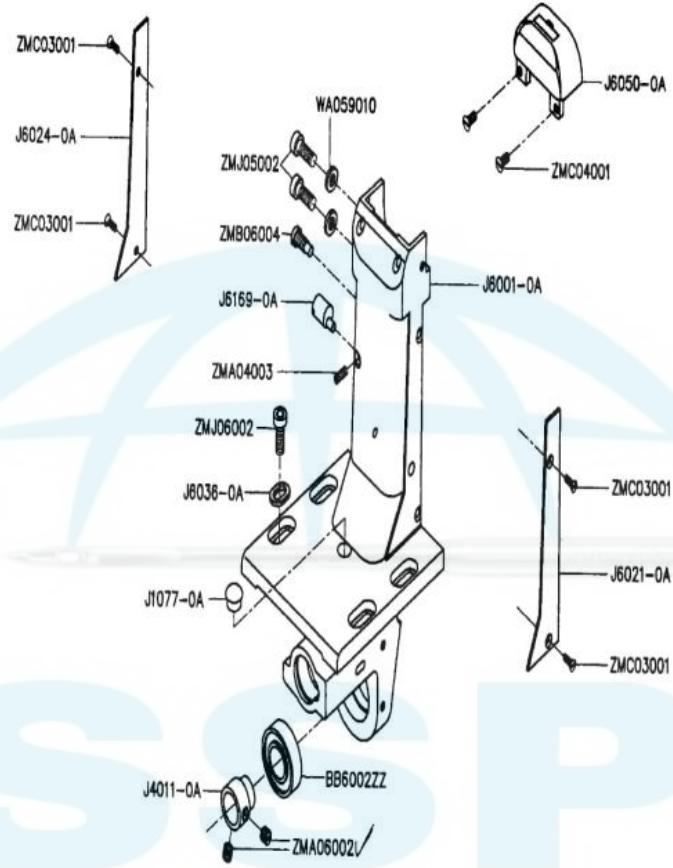

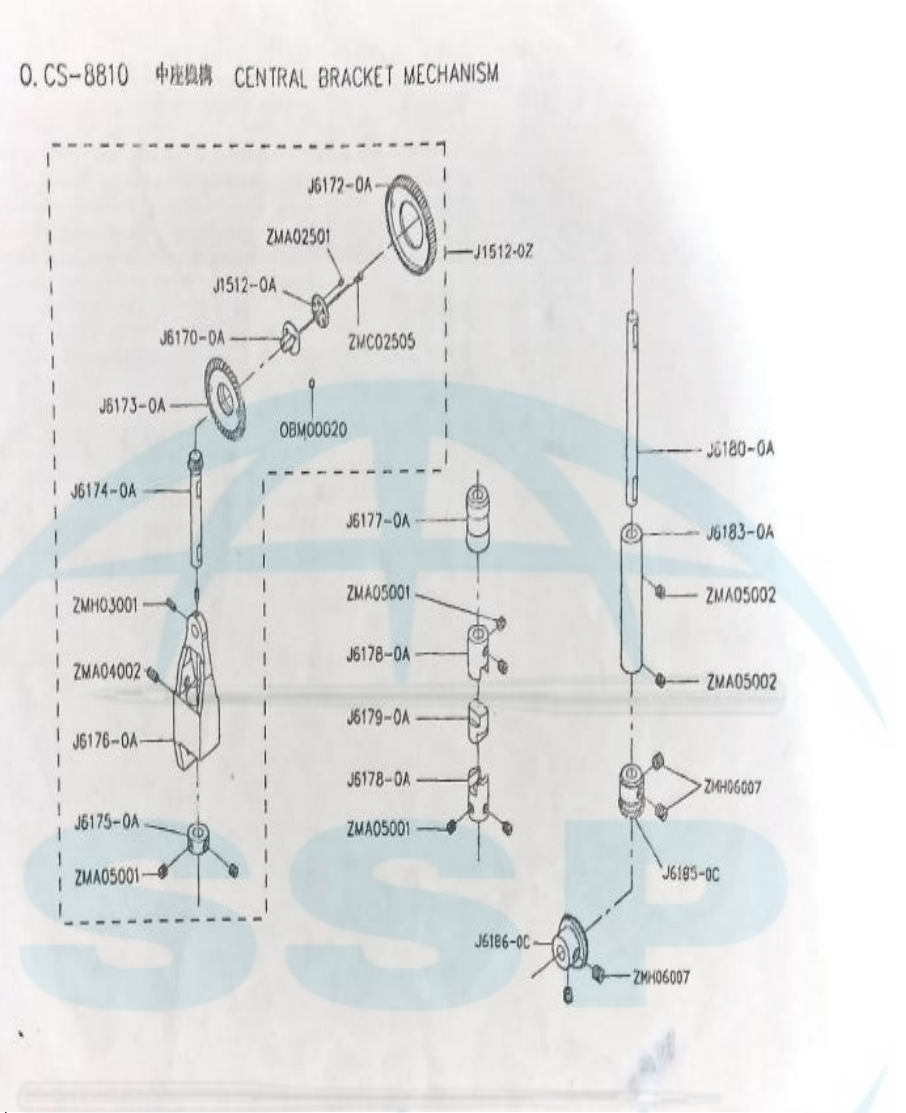
PART NO:	9910/9920 POST BED MACHINE			
J1512-0A				
J6170-0A				
J6172-0A				
J6173-0A				
J6174-0A				
J6175-0A				
J6176-0A				
J6177-0A				
J6178-0A				
J6179-0A				
J6180-0A				
J6183-0A				
J6185-0A				
J6186-0A				
OBM0002C				
ZMA02501				
ZMA04002				
ZMA05001				
ZMA05002				
ZMA06002				
ZMC02505				
ZMH03001				

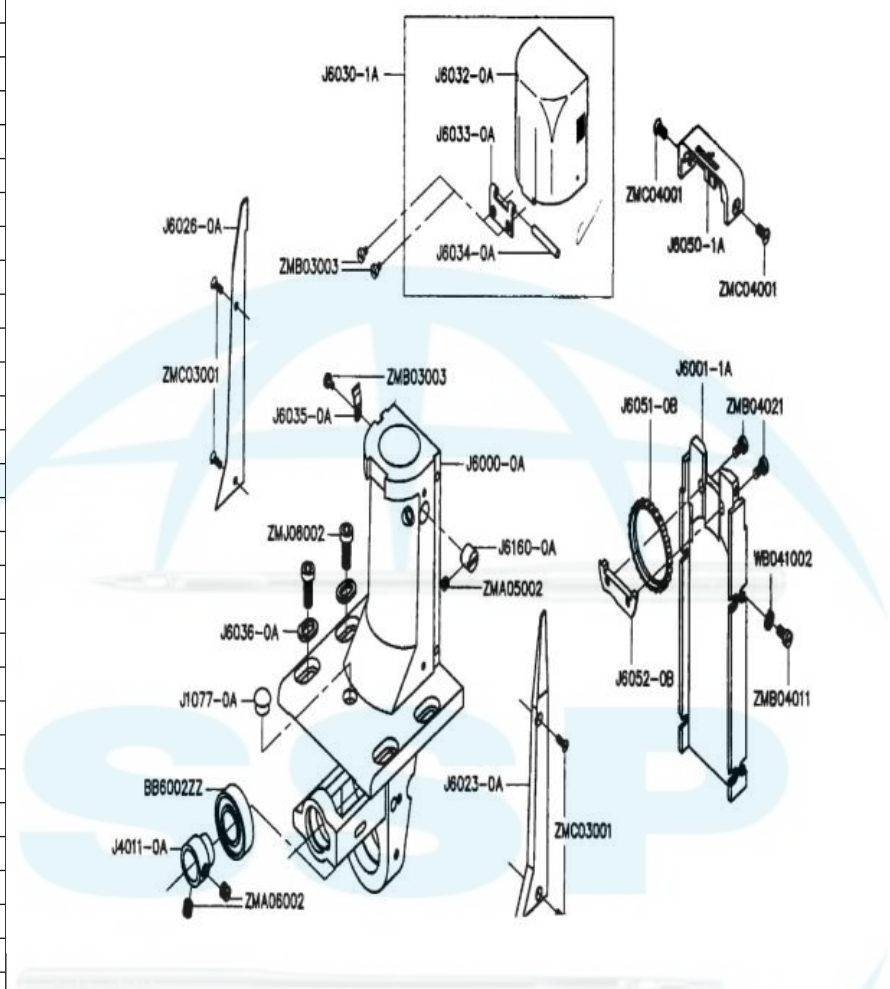
PART NO:	9910/9920 POST BED MACHINE		
BB6002ZZ			
J1077-0A			
J4011-0A			
J6000-0A			
J6001-0A			
J6023-0A			
J6026-0A			
J6030-0A			
J6032-0A			
J6033-0A			
J6034-0A			
J6035-0A			
J6036-0A			
J6050-0A			
J6051-0A			
J6052-0A			
J6160-0A			
WB041002			
ZMA05002			
ZMA06002			
ZMB03003			
ZMB04011			
ZMB04021			
ZMC03001			
ZMC04001			
ZMJ06002			

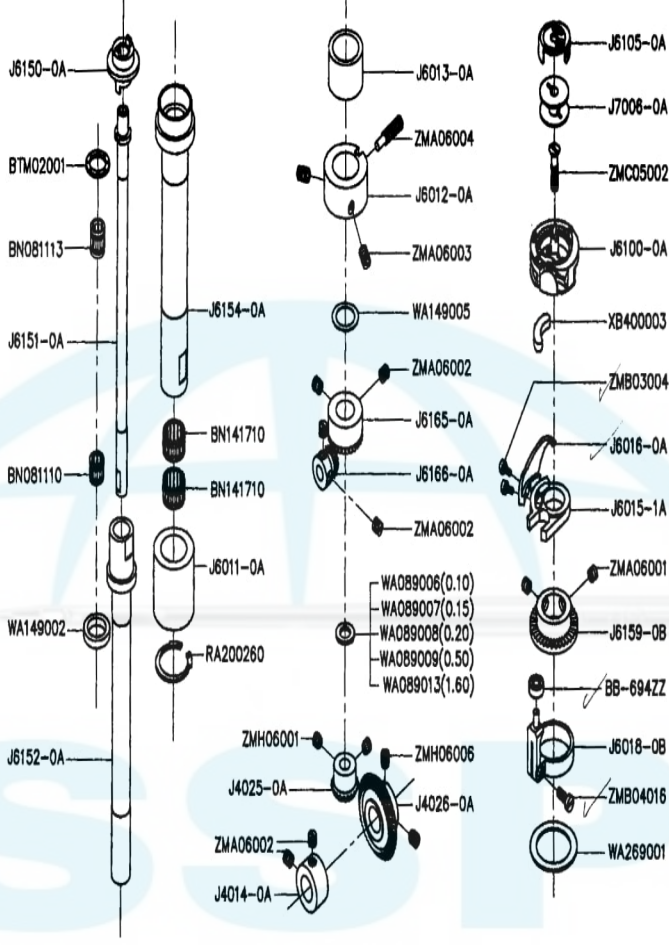
PART NO:	9910/9920 POST BED MACHINE		
BB-694ZZ	<p data-bbox="432 286 935 320">Q. BM-9920 左边座机构 LEFT SIDE BRACKET MECHANISM</p> 		
BNO81110			
BNO81113			
BN141710			
BTM02001			
J4014-0A			
J4025-0A			
J4026-0A			
J6011-0A			
J6012-0A			
J6013-0A			
J6015-0A			
J6016-0A			
J6018-0A			
J6100-0A			
J6105-0A			
J6150-0A			
J6151-0A			
J6152-0A			
J6154-0A			
J6159-0A			
J6765-0A			
J6166-0A			
J7006-0A			
RA200260			
WA089006			
WA089007			
WA089008			
WA089009			
WA089013			
WA149002			
WA149005			
WA269001			

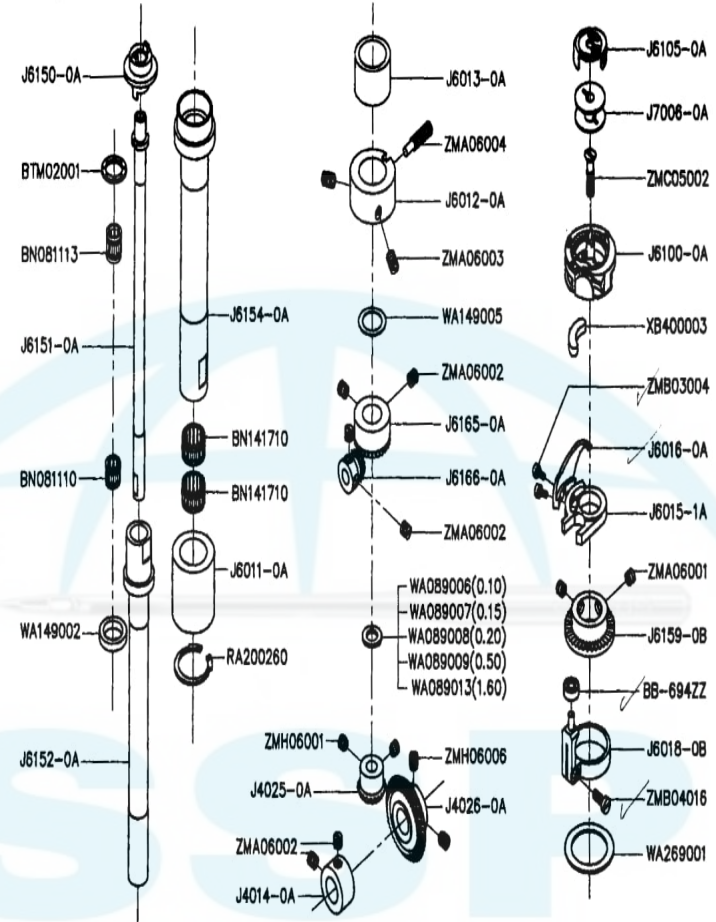
PART NO:	9910/9920 POST BED MACHINE			
XB400003	<p data-bbox="430 302 957 336">Q. BM-9920 左边座机构 LEFT SIDE BRACKET MECHANISM</p> 			
ZMA06001				
ZMA06002				
ZMA06003				
ZMA06004				
ZMB03004				
ZMB04016				
ZMC05002				
ZMH06001				
ZMH06006				

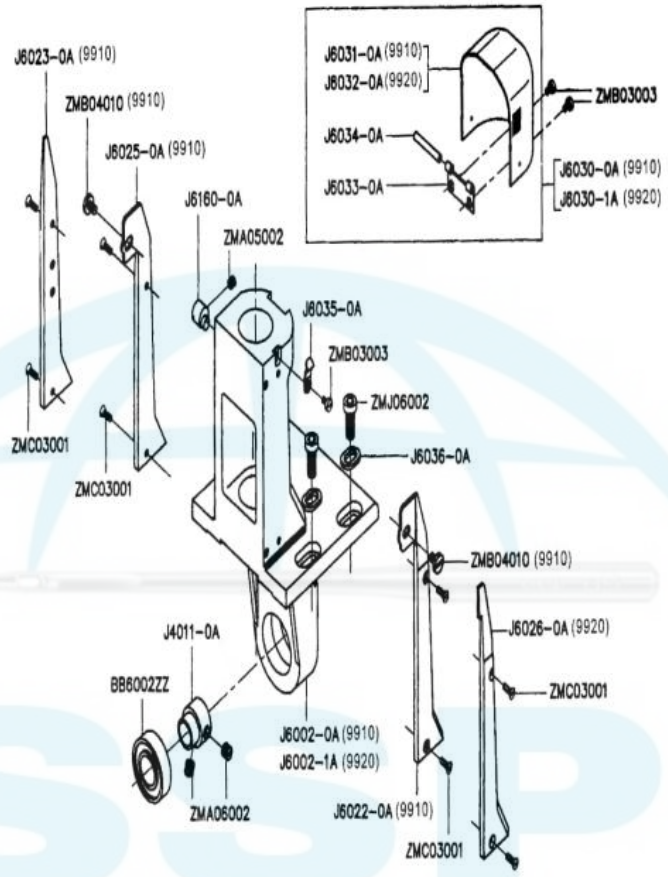

PART NO:	9910/9920 POST BED MACHINE		
BB-608ZZ	<p data-bbox="438 309 1257 338">R. BM-9910 · BM-9920 送齿轮单向前进机构 FEED WHEEL SINGLE-DIRECTION DRIVING MECHANISM</p>		
BNO61014			
BWGE4E01			
BWGE4E03			
J4022-OA			
J6190-OA			
J6191-OA			
J6193-OA			
J6195-OA			
RA200220			
XB116002			
ZMB04005			
ZMB04013			
ZMB04014			
ZMB04015			
ZMB06002			
ZML04001			

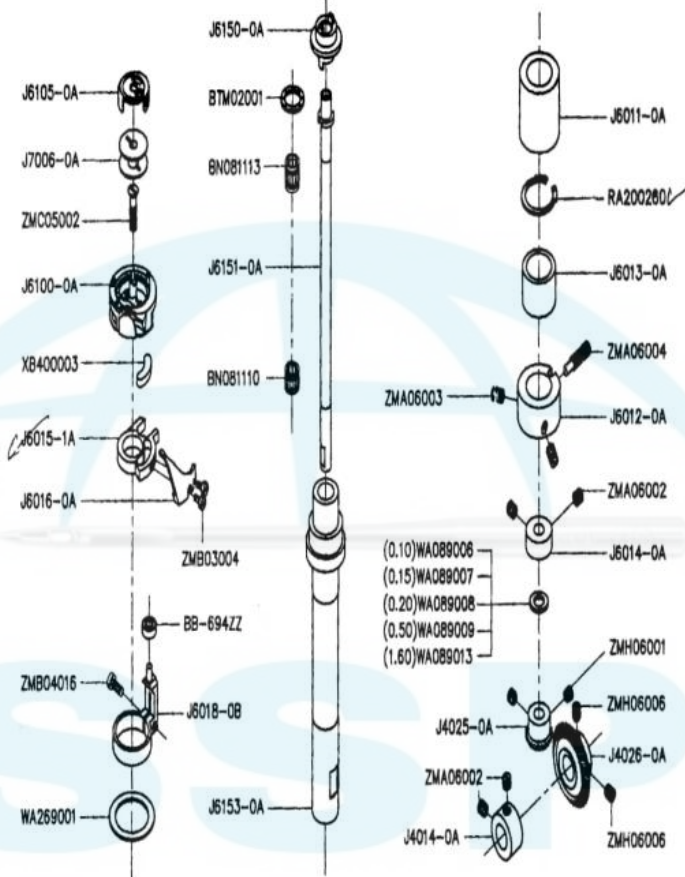
PART NO:	9910/9920 POST BED MACHINE		
BB6002ZZ	<p data-bbox="446 324 1037 358">S. BM-9910 · BM-9920 右边座机构 RIGHT SIDE BRACKET MECHANISM</p> 		
J4011-0A			
J6002-0A			
J6002-1A			
J6022-0A			
J6023-0A			
J6025-0A			
J6026-0A			
J6030-0A			
J6030-1A			
J6031-0A			
J6032-0A			
J6034-0A			
J6035-0A			
J6036-0A			
J6160-0A			
ZMA05002			
ZMA06002			
ZMB03003			
ZMB04010			
ZMC03001			
ZMJ06002			

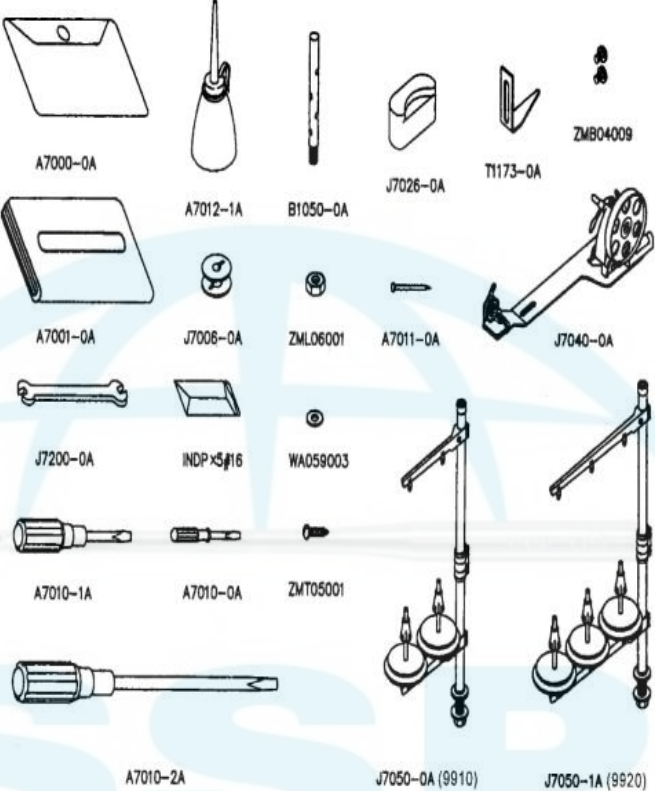
PART NO:	9910/9920 POST BED MACHINE			
BB-694ZZ	<p data-bbox="422 324 1021 358">S. BM-9910 · BM-9920 右边边座机构 RIGHT SIDE BRACKET MECHANISM</p> 			
BNO81110				
BNO81113				
BTM02001				
J4014-0A				
J4025-0A				
J4026-0A				
J4011-0A				
J4012-0A				
J4013-0A				
J4014-0A				
J4015-1A				
J4016-0A				
J4018-0A				
J6100-0A				
J6105-0A				
J6150-0A				
J6151-0A				
J6153-0A				
J7006-0A				
RA200260				
WA089006				
WA089007				
WA089008				
WA089009				
WA089013				
WA269001				
XB400003				
ZMA06002				
ZMA06003				
ZMA06004				
ZMB03004				
ZMB04016				
ZMC05002				
ZMH06001				
ZMH06006				

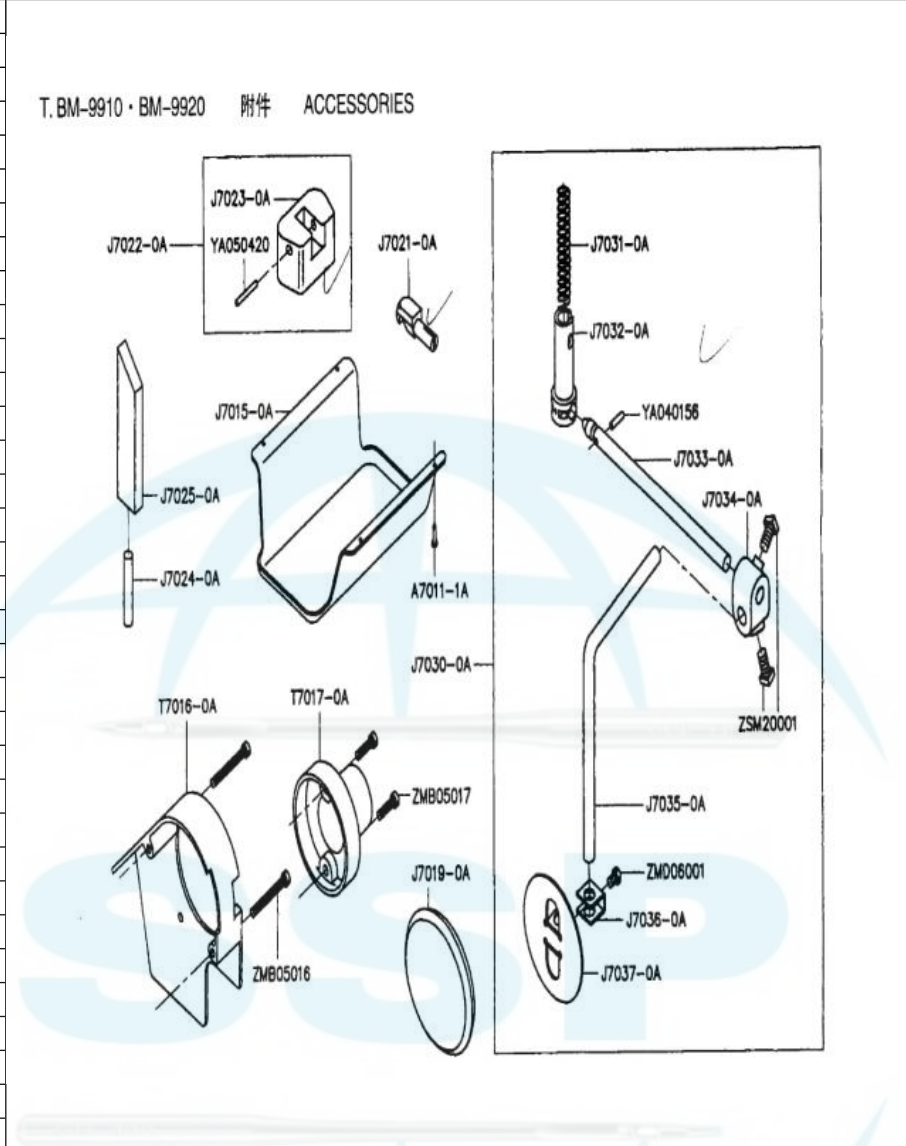
PART NO:	9910/9920 POST BED MACHINE			
A7000-0A	<p data-bbox="443 342 826 376">T. BM-9910 · BM-9920 附件 ACCESSORIES</p>  <p>The diagram shows various accessories for the T. BM-9910 and BM-9920 machines. It includes: A7000-0A (envelope), A7012-1A (needle), B1050-0A (needle), J7026-0A (hook), T1173-0A (hook), ZMB04009 (hook), A7001-0A (cover), J7006-0A (cover), ZML06001 (cover), A7011-0A (cover), J7040-0A (cover), J7200-0A (cover), INDP x5#16 (cover), WA059003 (cover), A7010-1A (cover), A7010-0A (cover), ZMT05001 (cover), A7010-2A (cover), J7050-0A (9910) (cover), and J7050-1A (9920) (cover).</p>			
A7001-0A				
A7010-0A				
A7010-1A				
A7010-2A				
A7011-0A				
A7012-0A				
B1050-0A				
INDPX5#16				
J7006-0A				
J7026-0A				
J7040-0A				
J7050-0A				
J7050-1A				
J7200-0A				
T1173-0A				
WA059003				
ZMB04009				
ZML06001				
ZMT05001				

PART NO:	9910/9920 POST BED MACHINE		
A7011-0A	<p>T. BM-9910 · BM-9920 附件 ACCESSORIES</p> 		
J7015-0A			
J7019-0A			
J7021-0A			
J7022-0A			
J7023-09A			
J7024-0A			
J7025-0A			
J7030-0A			
J7031-0A			
J7032-0A			
J7033-0A			
J7034-0A			
J7035-0A			
J7036-0A			
J7037-0A			
T7016-0A			
T7017-0A			
YA040156			
YA050420			
ZMB05016			
ZMB05017			
ZMD06001			
ZSM20001			

PART NO:	9910/9920 POST BED MACHINE				
J1075-010A (2.8)	U. BM-9910 · BM-9920 针位图号详表 GAUGE PARTS LIST  J1075-0A  J6050-1A  J6050-0A				
J1075-020A (3.2)					
J1075-030A (5.5)					
J1075-040A (3.0)					
J1075-050A (2.4)					
J1075-080A (4.0)					
J6050-011A (1.6,2.0)					
J6050-031A (3.2)					
J6050-041A (5.5)					
J6050-051A (1.6)					
J6050-061A (1.6)					
J6050-071A (2.8)					
J6050-010A (S.H)					
J6050-071A (C.H)					



**WORLD
STITCH**

Mob:-9163721786
Email:-worldstitch786@gmail.com

