

本體部分

大目

ARM BED AND ITS ACCESSORIES

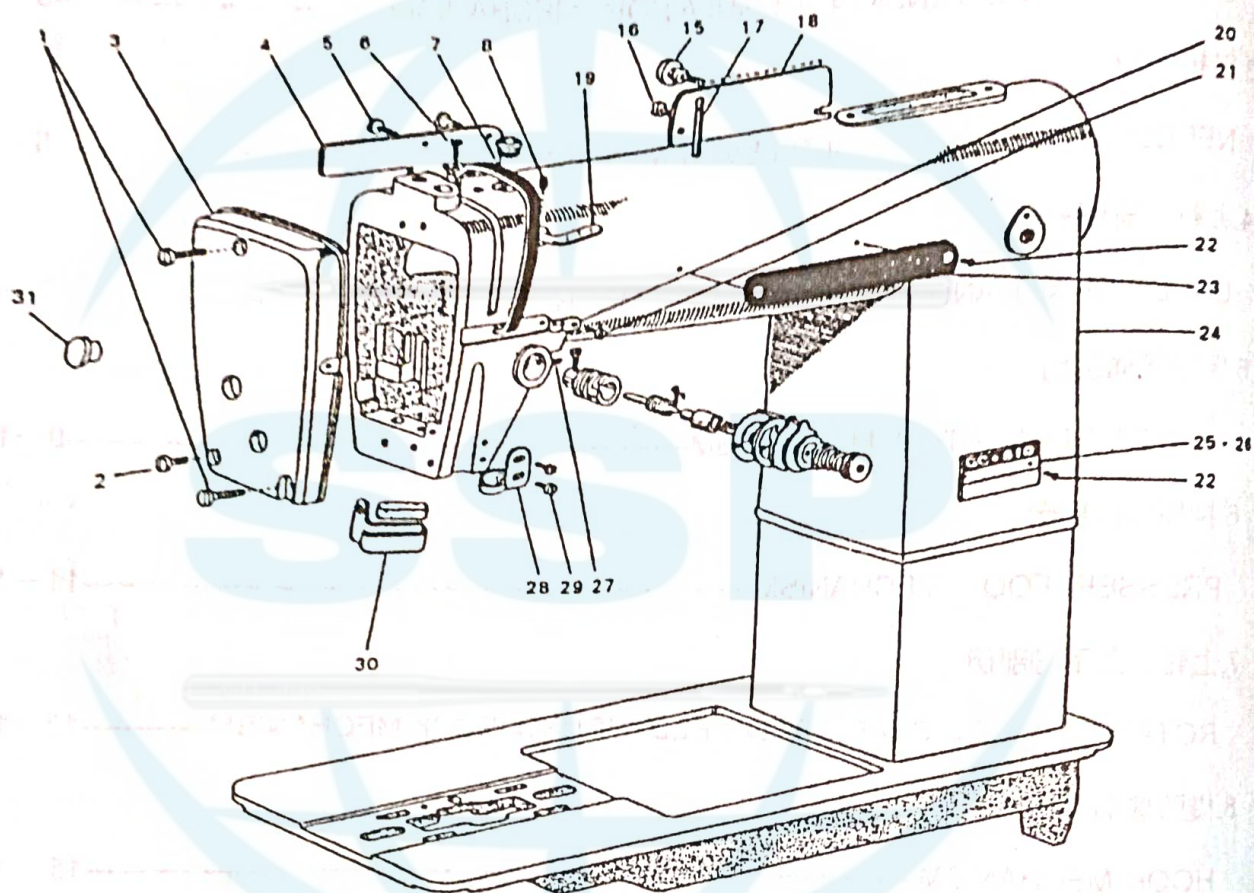

本体部份  
ARM BED AND ACCESSORIES

Fig. No.	Part No. 零件號碼	部 品 名	Name of part	個 / 台 Amt/req	
				2000-5	2000-5
1	8100101-00	螺絲	Screw(fo Fig.3)	3	3
2	8100102-00	螺絲	Screw(fo Fig.3)	1	1
3	8100103-00	面板	Face plate	1	1
	8100103-01	面板	Face plate For MS-5510	1	1
4	8100104-00	防沙板(小)	Side cover	1	1
5	8100105-00	螺絲	Screw(for Fig.4)	1	1
6	8100106-00	螺絲	Screw(for Fig.7)	1	1
7	8100107-00	天秤蓋	Thread take-up cover	1	1
8	8100108-00	螺絲	Set screw(for Fig.19)	1	
15	8100115-00	螺絲	Screw(for Fig.18)	1	1
16	8100116-00	螺絲	Screw(for Fig.18)	1	1
17	8100117-00	過綫梢	Spool.pin	1	2
18	8100118-00	防沙板(大)	Arm side cover	1	1
19	8100119-00	三孔過綫杆	3 hole thread retainer	1	
20	8100120-00	過綫杆	Thread guide(arm)	1	1
21	8100121-00	螺絲	Screw(for Fig.20)	1	1
22	8100122-00	牌釘	Pin(for Fig.23)	4	4
23	8100123-00	名牌	Name plate	1	2
24	8100124-00	本體	Arm and bed	1	1
25	8100125-00	型號牌	Model plate	1	
26	8100126-00	型號牌	Model plate		1
27	8100127-00	螺絲	Set screw(for Fig.002)		1
28	8100128-00	過綫杆(下臂)	Thread guide(under arm)	1	1
29	8100129-00	螺絲	Screw(for Fig.28)	1	1
30	8100130-00	過綫	Thread guide		1
31	8100131-00	油塞	Rubber cork	2	2

調節器部份

UPPER THREAD TENSION REGULATOR MECHANISM

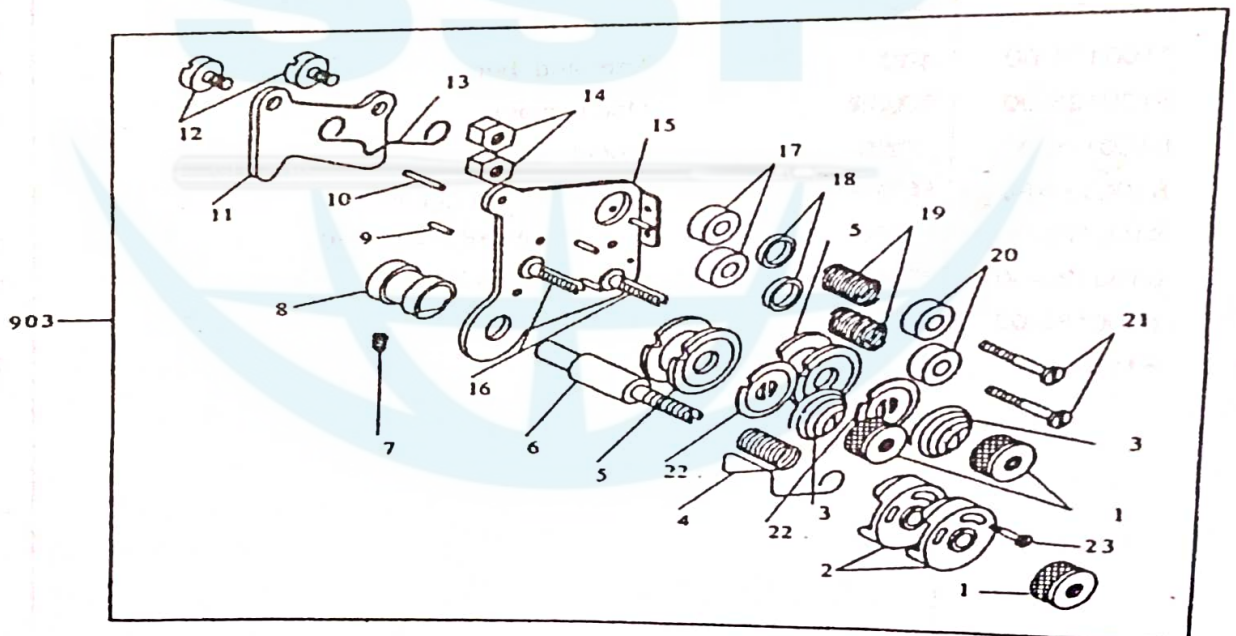
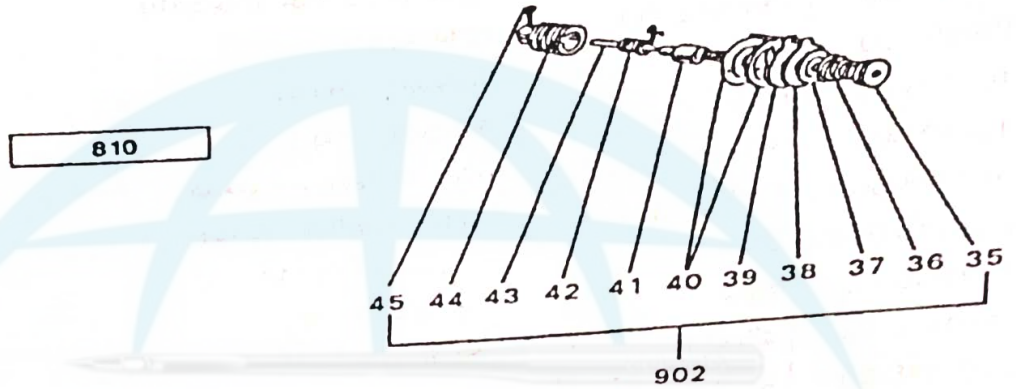



## 調節器部份

## UPPER THREAD TENSION REGULATOR MECHANISM

個/台  
Amt. req

Fig No.	Part No 零件號碼	部 品 名	Name of part	個/台	
				2000-5	2000-6
902	81003902-00	沙拉組 (單針)	Thread tension regulator Assy	1	
903	81003903-00	沙拉組 (雙針)	Thread tension regulator Assy		1
1	8100301-00	螺帽	Nut	2	2
2	8100302-00	過線盤組	Spring Guide Assy	1	2
3	8100303-00	調整彈簧	Tension Spring	1	2
4	8100304-00	吊線彈簧	Thread Take-up Spring	1	1
5	8100305-00	壓線盤	Tension Disc	2	4
6	8100306-00	調整螺絲杆	Thread Tension Stud	1	1
7	8100307-00	螺絲	Screw	1	1
8	8100308-00	彈簧座	Thread Tension Regulator Bushing	1	1
9	8100309-00	鬆線梢	Tension Releasing Pin	1	1
10	8100310-00	鬆線梢	Tension Releasing Pin	1	1
11	8100311-00	彈簧板	Tension Release Plate	1	1
12	8100312-00	螺絲	Screw	2	2
13	8100313-00	壓板彈簧	Tension Release Spring	1	1
14	8100314-00	螺帽	Nut	1	1
15	8100315-00	上線壓力板	Upper Thread Tension Plate	1	1
16	8100316-00	調整螺絲杆	Thread Tension Stud	1	2
17	8100317-00	過線孔蓋	Thread Guide Bracket	1	2
18	8100318-00	過線孔圓盤	Thread Guide Disc	1	2
19	8100319-00	導線彈簧	Thread Guide Spring	1	2
20	8100320-00	過線孔內蓋	Thread Guide Cap	1	2
21	8100321-00	螺絲	Screw	1	2
22	8100322-00	線調整壓盤	Tension disc Washer	1	2
23	8100323-00	螺絲	Screw	1	1
25	8100325-00	鬆線梢	Tension Releasing Pin	1	1
26	8100326-00	襯套環	Bushing	1	1
27	8100327-00	螺絲	Screw	1	1
28	8100328-00	螺絲	Screw	1	1
35	8100335-00	沙拉調節螺帽	Thread tension regulating thumb nut	1	
36	8100336-00	沙拉彈簧	Thread tension spring	1	
37	8100337-00	沙拉片	Thread tension releasing disc	1	
38	8100338-00	沙拉擋片	Tension regulator stop plate	1	
39	8100339-00	沙拉墊片	Tension regulator bracket	1	
40	8100340-00	沙拉片	Tension disc	2	
41	8100341-00	沙拉螺柱	Thread tension stud	1	
42	8100342-00	沙拉拉起彈簧	Thread take-up spring	1	
43	8100343-00	沙拉鬆梢	Thread tension releasing pin	1	
44	8100344-00	沙拉調整襯片	Thread tension regulator bushing	1	
45	8100345-00	螺絲	Set screw(for Fig.41)	1	

針棒部分

NEEDLE BAR AND TAKE-UP LEVER MECHANISM

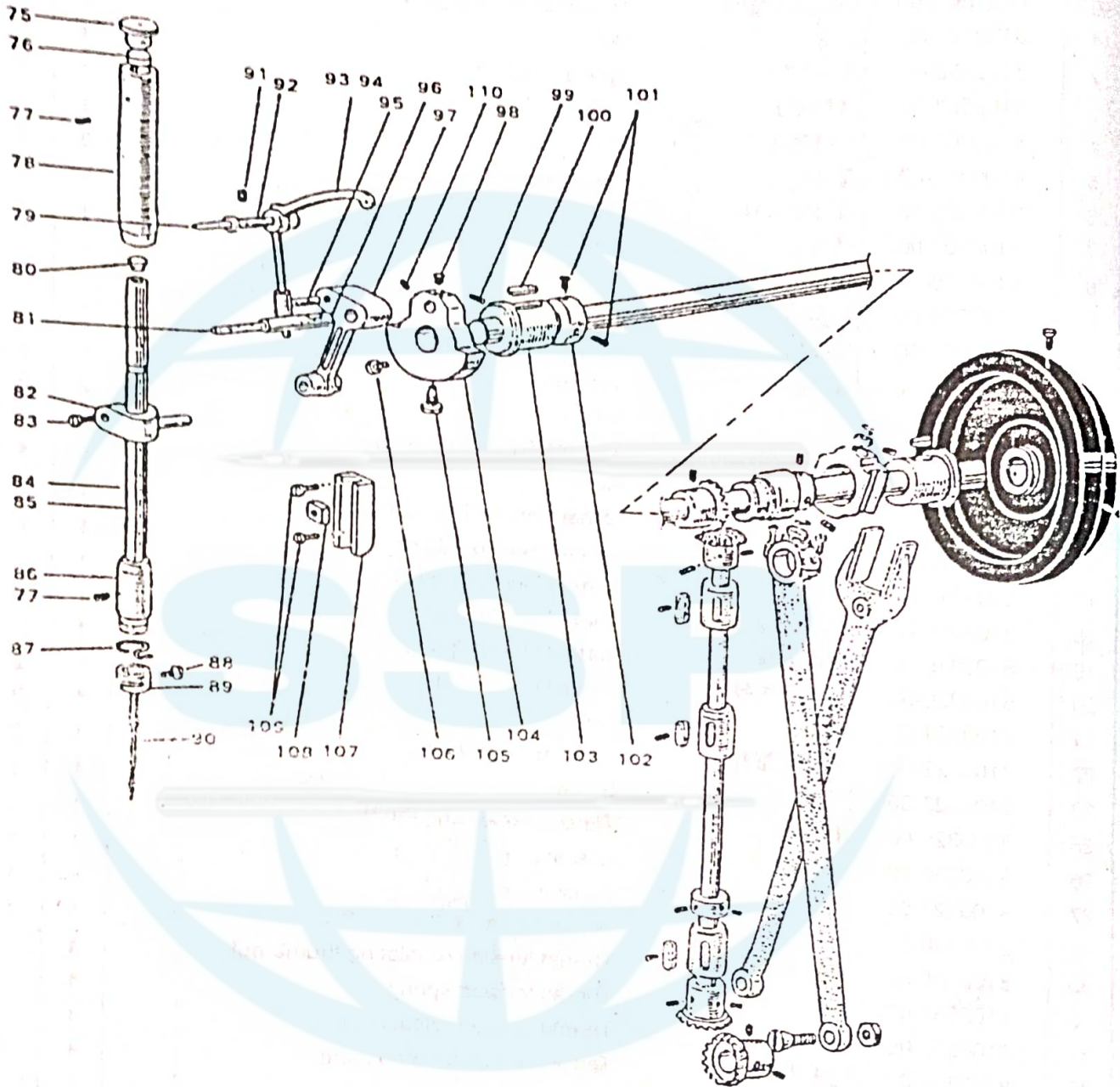



## 針 桿 部 份

## NEEDLE BAR AND TAKE-UP LEVER MECHANISM

圖/名	
Amt./req	

Fig No.	Part No 零件號碼	部 品 名	Name of part	圖/名	
				ZAV	ZAV
75	8100575-00	橡膠蓋	Needle bar upper bushing cap	1	1
76	8100576-00	羊毛氈墊片	Needle bar upper bushing cap felt	1	1
77	8100577-00	螺絲	Set screw(for Fig.78)	2	2
78	8100578-00	針桿套筒(上)	Needle bar bushing(upper)	1	1
79	8100579-00	油心	Oil wick	2	2
80	8100580-00	塑膠塞	Plastic plug(for Fig.84,85)	1	1
81	8100581-00	油墊	Felt	1	1
82	8100582-00	針桿拉基	Needle bar connecting stud	1	1
83	8100583-00	螺絲	Screw(for Fig.82)	1	1
84	8100584-00	單針針桿	Needle bar	1	
85	8100585-00	雙針針桿	Needle bar		1
86	8100586-00	針桿套筒(下)	Needle bar bushing(under)	1	1
87	8100587-00	單針用過線	Thread guide	1	
88	8100588-00	針檔螺絲	Needle clamp screw	1	
89	8100589-00	單針針桿過線	Thread guide	1	
90	8100590-00	針	Needle	1	2
91	8100591-00	螺絲	Set screw(for Fig.92)	1	1
92	8100592-00	天秤軸	Take-up lever support stud	1	1
93	8100593-00	單針天秤	Take-up lever	1	
94	8100594-00	雙針天秤	Take-up lever		1
95	8100595-00	天秤滑棒	Take-up slide block	1	1
96	8100596-00	連杆梢	Crank pin	1	1
97	8100597-00	針桿滑棒	Needle bar connecting crank rod	1	1
98	8100598-00	螺絲組	Set screw(for Fig.104)	1	1
99	8100599-00	羊毛氈墊片	Set screw(for Fig.103)	3	3
100	81005100-00	油墊	Felt	2	2
101	81005101-00	螺絲組	Set screw(for Fig.102)	2	2
102	81005102-00	上軸套	Upper shaft collar	1	1
103	81005103-00	上軸襯(左)	Upper shaft bushing(left)	1	1
104	81005104-00	曲柄	Crank	1	1
105	81005105-00	螺絲	Set screw(for Fig.104)	1	1
106	81005106-00	螺絲	Set screw(for Fig.104)	1	1
107	81005107-00	滑塊槽	Needle bar connecting link guide	1	1
108	81005108-00	針桿導塊	Square block(for Fig.82)	1	1
109	81005109-00	螺絲	Screw(for Fig.107)	2	2
110	81005110-00	螺絲	Screw(for Fig.104)	1	1

上軸、豎軸部分

UPPER SHAFT AND VERTICAL SHAFT MECHANISM

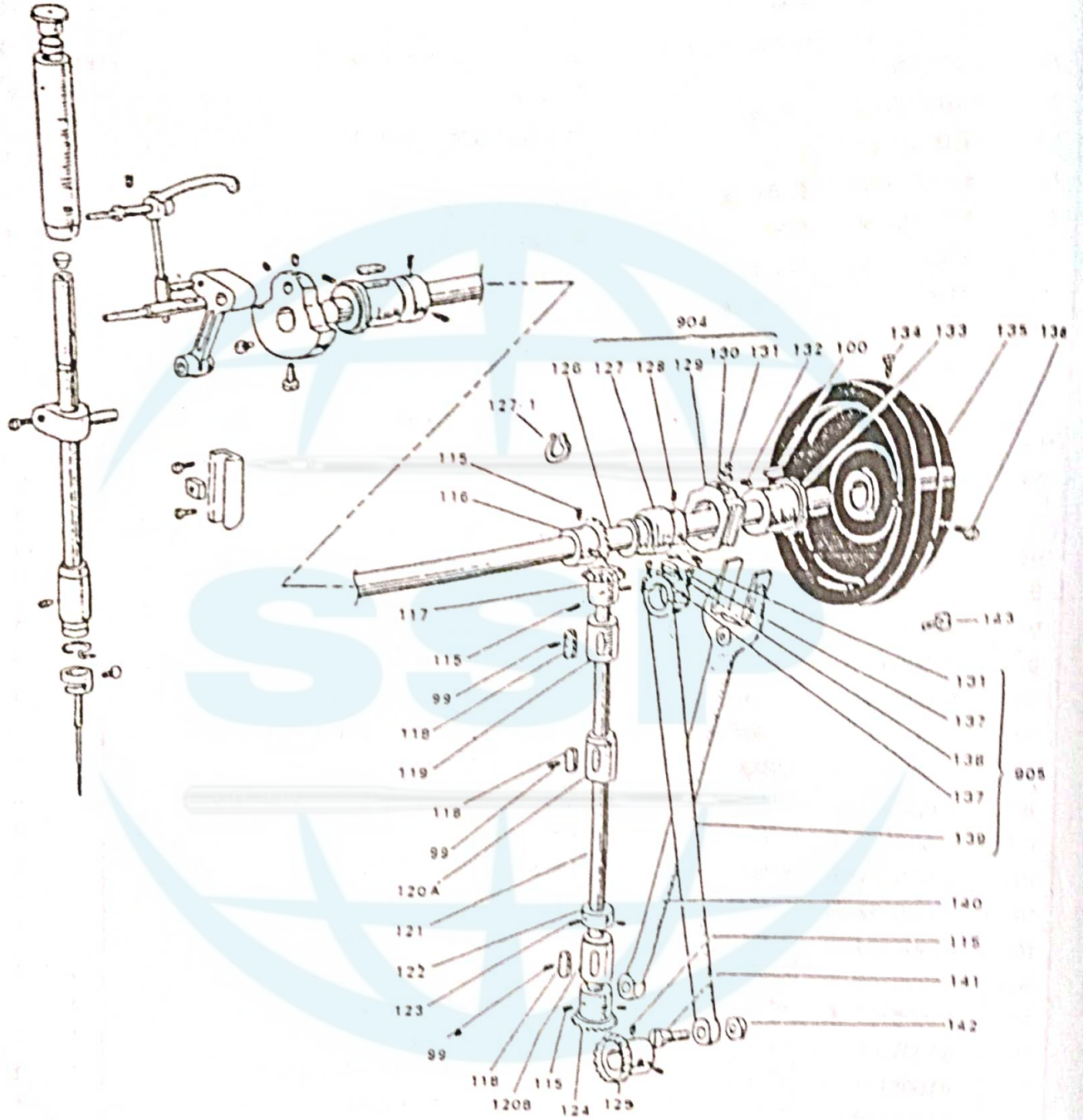



上軸，豎軸部份

UPPER SHAFT AND VERTICAL SHAFT MECHANISM

個/台  
Amt.req

Fig No	Part No 零件號碼	部 品 名	Name of part	個/台	
				2005	2009
115	81007115-00	螺絲	Set screw(for Fig.115)	1	1
116	81007116-00	斜齒輪(上軸)	Bevel gear(upper shaft)	1	1
117	81007117-00	豎軸齒輪	Bevel gear(vertical shaft upper)	2	2
118	81007118-00	羊毛氈墊片	Felt	1	1
119	81007119-00	豎軸襯套(上)	Vertical shaft bushing(upper)	2	2
120-A	81007120-0A	豎軸襯套(中)	Vertical shaft bushing(upper)	1	1
120-B	81007120-0B	豎軸襯套(下)	Vertical shaft bushing	1	1
121	81007121-00	豎軸	Vertical shaft	1	1
122	810087122-00	豎軸套環	Vertical shaft collar	1	1
123	81007123-00	螺絲	Setscrew(for Fig.122)	1	1
124	81007124-00	斜齒輪(豎軸) 21T	Bevel gear(vertical shaft under)	1	1
125	81007125-00	斜齒輪(梭軸) 18T	Bevel gear(hook shaft)	1	1
126	81007126-00	上軸	Upper shaft	1	1
904	81007904-00	凸輪進給組(毛毛組)	Feed cam Assy	1	1
127	81007127-00	凸輪進給	Feed cam	1	1
127-1	81007127-01	C型扣環	Ring	1	1
128	81007128-00	螺絲	Set screw(for Fig.127)	2	2
129	81007129-00	凸輪進給套圈	Feed cam ring	1	1
130	81007130-00	油墊	Felt	2	2
131	81007131-00	彈簧(S鈎)	Spring(for Fig.130)	2	2
132	81007132-00	螺絲	Set screw(for Fig.133)	1	1
133	81007133-00	上襯套(右)	Upper shaft bushing(right)	1	1
134	81007134-00	螺絲	Set screw(for Fig.135)	2	2
135	81007135-00	皮帶輪	Balance wheel	1	1
136	81007136-00	螺絲	Screw(for Fig.135)	1	1
905	81007905-00	連桿組	Crank rod Assy	1	1
137	81007137-00	螺絲	Screw(for Fig.139)	1	1
138	81007138-00	油墊	Felt	1	1
139	81007139-00	連杆	Crank rod	1	1
140	81007140-00	曲進連杆	Feed forked connection	1	1
141	81007141-00	連杆用螺絲	Crank rod taper screw(for Fig.139)	1	1
142	81007142-00	螺帽	Nut(for Fig.141)	1	1
143	81007143-00	螺絲	Screw	1	1



倒縫機構部分

STITCH REGULATOR MECHANISM

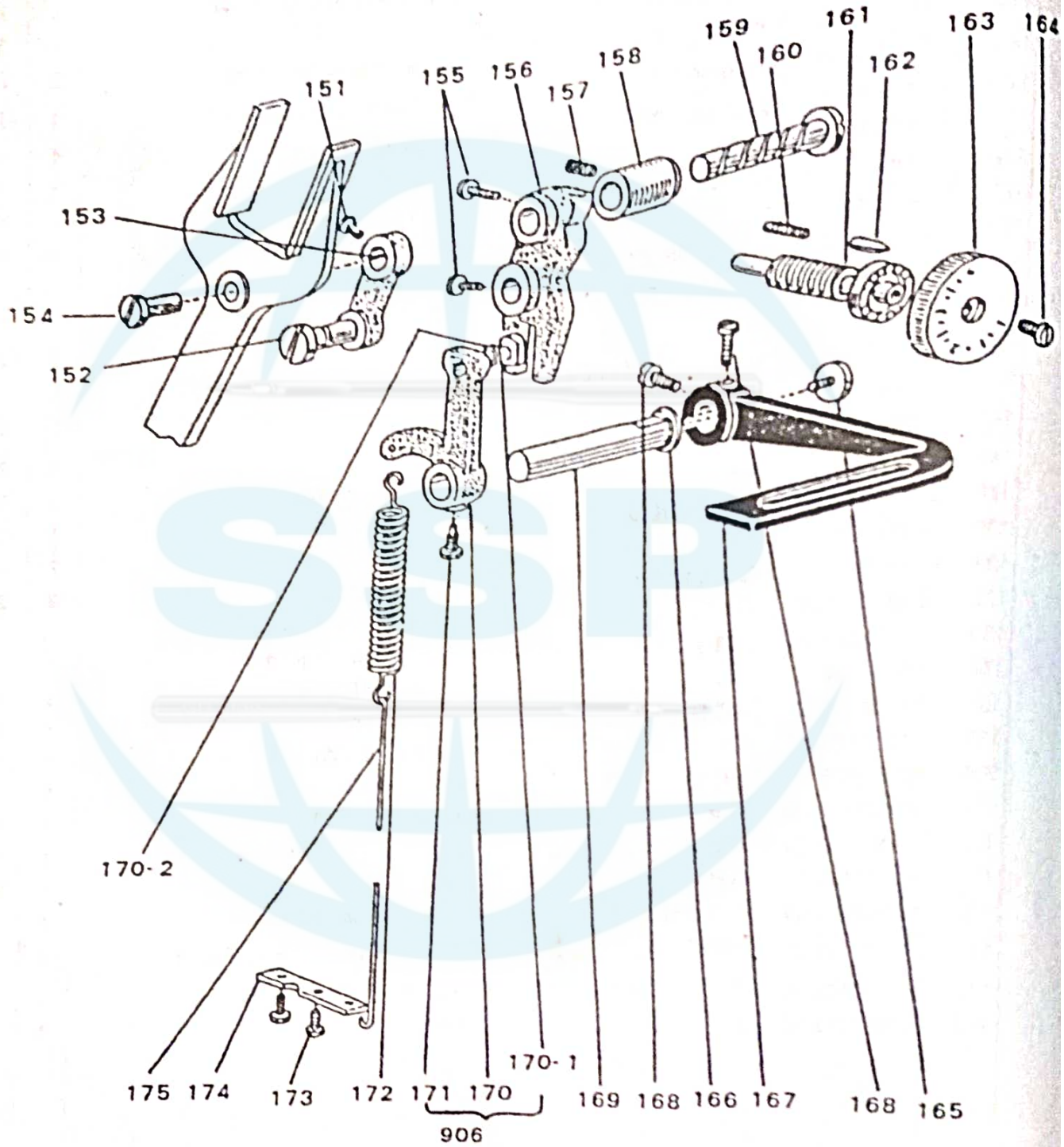

## 倒縫機構部份

## STITCHREGULATORMECHANISM

個/台  
Amt.req

Fig No.	Part No 零件號碼	部 品 名	Name of part	個/台 Amt.req	
				2000-5	2000-6
151	81009151-00	螺絲	Screw	1	1
152	81009152-00	梢	Set pin(for Fig.153)	1	1
153	81009153-00	連杆	Feed connecting link	1	1
154	81009154-00	連杆軸	Set pin(for Fig.153)	1	1
155	81009155-00	螺絲	Set screw(for Fig.156)	2	2
156	81009156-00	進給調整	Feed regulator	1	1
157	81009157-00	螺絲	Set Screw(for Fig.158)	3	3
158	81009158-00	進給調節襯套	Feed Regulator bushing	1	1
159	81009159-00	梢	Set pin(for Fig.156)	1	1
160	81009160-00	彈簧	Spring(for Fig.162)	1	1
161	81009161-00	針距調整螺絲	Screw-bar for(MS-5510.5520)	1	1
162	81009162-00	檔梢	Stopper pin(for Fig.163)	1	1
163	81009163-00	針距調整盤	Stitch length regulator dial	1	1
164	81009164-00	螺絲	Screw(for Fig.163)	1	1
165	81009165-00	螺絲	Screw(for Fig.167)	1	1
166	81009166-00	彈簧華司	Spring washer(for Fig.167)	1	1
167	81009167-00	倒縫杆	Reverse sewing lever	1	1
168	81009168-00	螺絲	Set screw(for Fig.167)	2	2
169	81009169-00	軸	Shaft(for Fig.167)	1	1
906	81009906-00	倒縫連杆組	Reverse sewing crank Assy	1	1
170	81009170-00	倒縫連杆	Reverse sewing lever	1	1
171	81009171-00	螺絲	Set screw(for Fig.170)	1	1
172	81009172-00	彈簧	Spring(for Fig.170)	1	1
173	81009173-00	螺絲	Screw(for Fig.174)	2	2
174	81009174-00	固定板	Bracket(for Fig.172)	1	1
175	81009175-00	拉升杆	Knee lifter rod	1	1



押棒機構部分

PRESSER FOOT MECHANISM

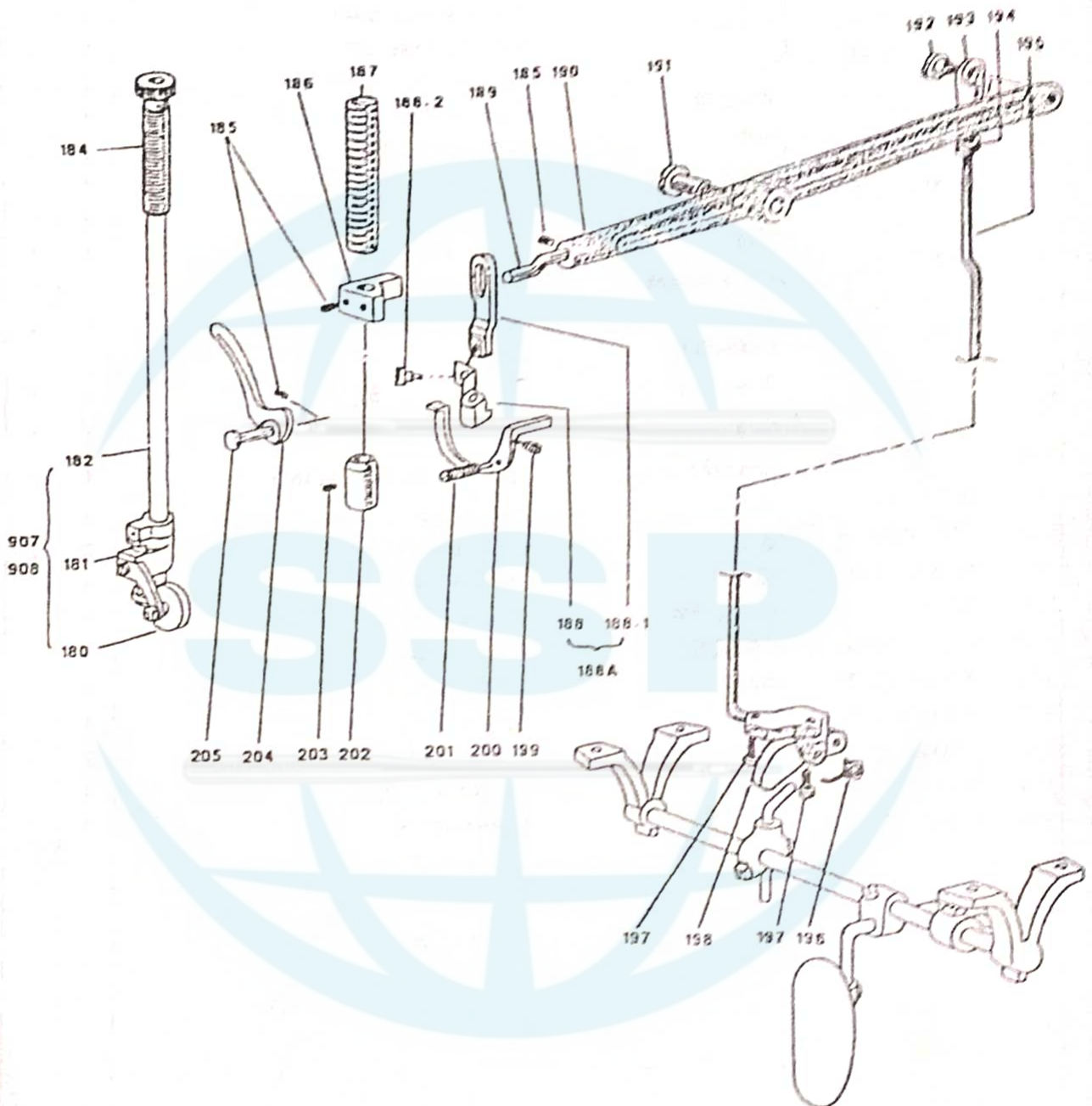

押棒機構部份

PRESSERFOOTMECHANISM

個/台  
Amt.req

Fig No.	Part No. 零件號碼	部 品 名	Name of part	個/台	
				2000-5	2000-6
907	81011907-00	押棒組	ollerpr esser bar Assy	1	
908	81011908-00	押棒組	ollerpr esser bar Assy		1
180	81011180-00	押腳組	ollerpr esser Assy	1	
181	81011181-00	押腳組	ollerpr esser Assy		1
182	81011182-00	押棒	resser bar Assy	1	
184	81011184-00	壓力調整螺絲	resser releasing thumd screw	1	1
185	81011185-00	螺絲	etscrew(for Fig.182.183)	3	3
186	81011186-00	押棒導塊	Resser bar holder	1	
187	81011187-00	彈簧	Resser spring	1	1
188	81011188-00	連杆座	Knee lifter lever link	1	1
188-1	81011188-01	連杆	Knee lifter lever link	1	1
188-2	81011188-02	螺絲	Screw(for Fig 188)	1	1
189	81011189-00	連梢	Knee lifter lever pin	1	1
190	81011190-00	腳弓大杆	Knee-lifter lever	1	1
191	81011191-00	腳弓螺絲	Knee lifter lifting lever hinge screw	1	1
192	81011192-00	螺絲	Screw(for Fig.193)	1	1
193	81011193-00	腳弓連接梢	Knee lifter lever joint	1	1
194	81011194-00	螺帽	Knee(for Fig 195)	1	1
195	81011195-00	腳弓連接棒	Knee lifter lever connection rod	1	1
196	81011196-00	彈簧	Spring(for Fig 198)	1	1
197	81011197-00	螺絲	Screw(for Fig.198)	2	2
198	81011198-00	腳弓連接支臂	Knee lifter lever connecting rod finder	1	1
199	81011199-00	彈簧	Spring(for Fig 200)	1	1
200	81011200-00	鬆緊杆	Tension releasing lever	1	1
201	81011201-00	螺絲	Setscrew(for Fig.200)	1	1
202	81011202-00	押棒襯套	Presser bar dushing	1	1
203	81011203-00	螺絲	Set screw(for Fig.202)	1	1
204	81011204-00	押棒升起	Presser bar lifter	1	1
205	81011205-00	押棒升起梢	Presser bar lifter pin	1	1



上軸、上下送軸部分

ROTATING HOOK SHAFT AND FEED LIFTING ROCK SHAFT MECHANISM

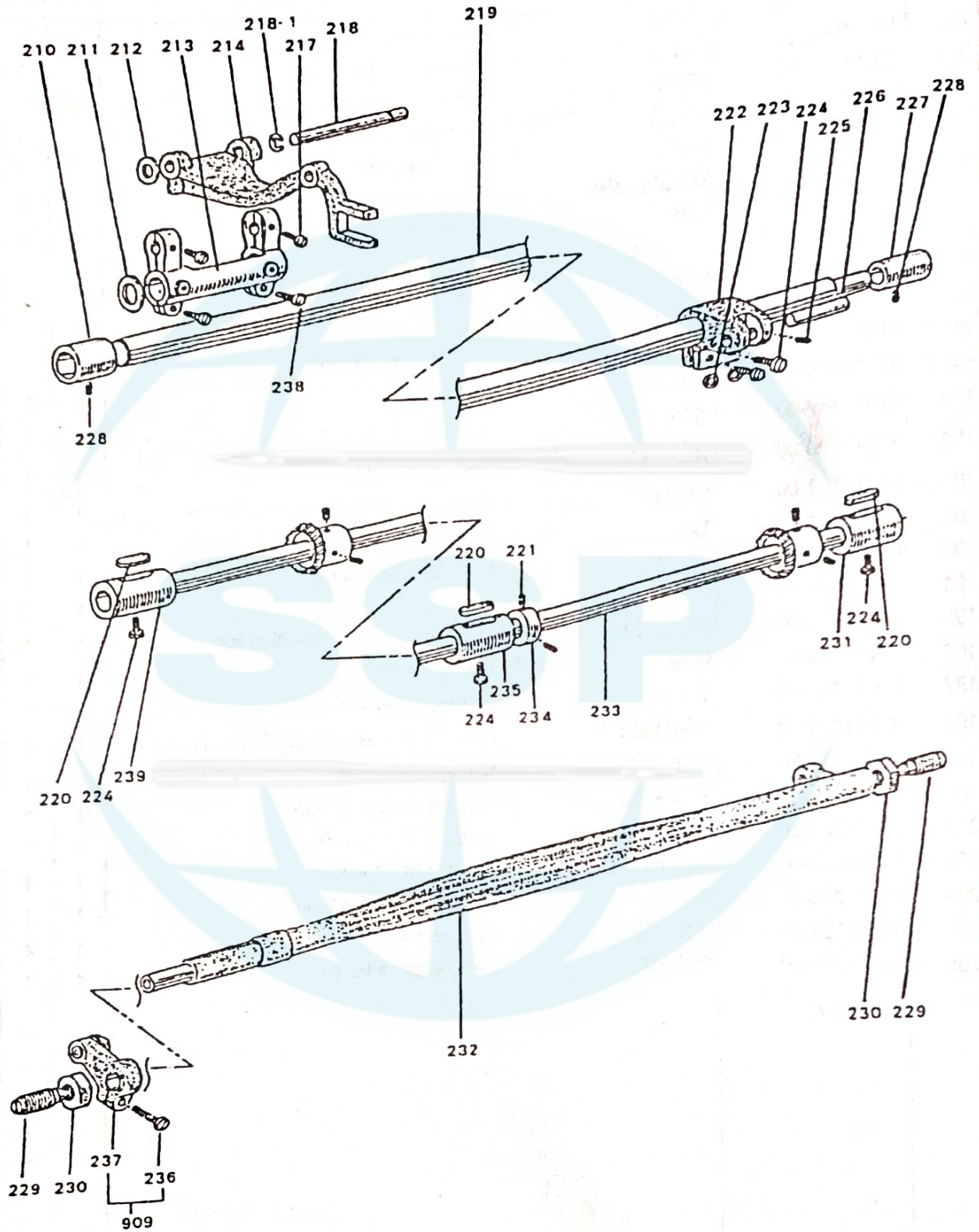

上軸、上下送軸部份

ROTATINGHOOKSHAFTANDFEEDLIFTINGROCKMECHANISM

Fig. No.	Part No. 零件號碼	部 品 名	Name of part	個/台	
				個/台	個/台
210	81013210-00	水平軸套筒 (左)	Feed rock shaft bushing(left)	1	1
211	81013211-00	墊片	Slide washer(for Fig 213)	1	1
212	81013212-00	墊片	Washer(for Fig 214)	1	1
213	81013213-00	送料腕 (左)	Feed rock shaft crank(left)	1	1
214	81013214-00	送料土臺	Feed bar	1	1
217	81013217-00	螺絲	Set screw(for Fig 218)	2	2
218	81013218-00	送料土臺支持軸	Feed bar shaft	1	1
218-1	81013218-01	扣環	Ring	1	1
219	81013219-00	水平軸	Feed rock shaft	1	1
220	81013220-00	油墊	Felt	3	3
221	81013221-00	螺絲	Set screw(for Fig 234)	2	2
222	81013222-00	送料腕 (右)	Feed rock shaft crank(right)	1	1
223	81013223-00	襯片	Washer(for Fig 224)	2	2
224	81013224-00	螺絲	Screw(for Fig 222)	5	5
225	81013225-00	螺絲	Set screw(for Fig 226)	1	1
226	81013226-00	送料腕、插梢 (右)	Feed rock shaft connecting pin	1	1
227	81013227-00	水平軸襯套	Feed rock shaft bushing(right)	1	1
228	81013228-00	螺絲	Screw(for Fig 227)	2	2
229	81013229-00	梢	Set pin(for feed rock crank rod)	2	2
230	81013230-00	螺帽	Nut(for Fig 229)	2	2
231	81013231-00	軸襯套	Rotation hook shaft bushing(right)	1	1
232	81013232-00	送料軸	Feed lifting rock shaft	1	1
233	81013233-00	下軸	Rotating hook shaft	1	1
234	81013234-00	套環	Collar(for Fig 233)	1	1
235	81013235-00	下軸襯套 (中)	Rotating hook shaft bushing(middle)	1	1
909	81013909-00	送料軸連杆組 (左)	Feed lifting rock shaft crank(left)Assy	1	1
236	81013236-00	螺絲	Screw(for Fig 237)	1	1
238	81013238-00	螺絲	Screw(for Fig 213)	1	1
239	81013239-00	下軸襯套	Rotating hook shaft bushing(left)	1	1



梭頭機構部分

HOOK MECHANISM

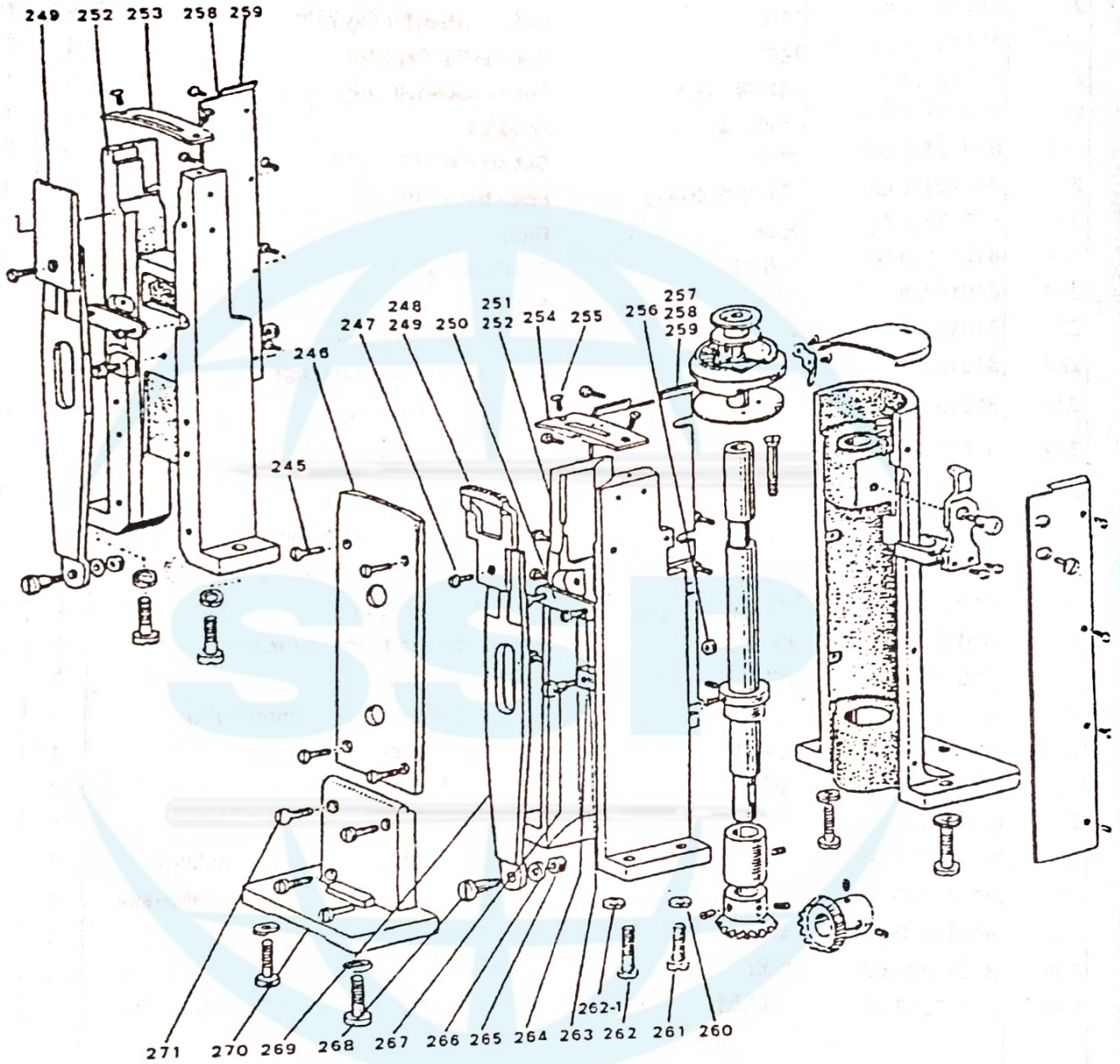

梭頭機構部份  
HOOKMECHANISM

Fig. No.	Part No. 零件號碼	部 品 名	Name of part	個 / 台 Amt.req	
				2000-5	2000-6
245	81015245-00	螺絲	Screw(for Fig 246)	4	
246	81015246-00	後蓋板	Rear cover plate	1	
247	81015247-00	螺絲	Screw(for Fig.248.249)	1	1
248	81015248-00	狗齒	Feed dog	1	
249	81015249-00	狗齒	Feed dog(1/16)		1
250	81015250-00	壓板	Supporter plate	1	1
251	81015251-00	中座	Feed plate set bracket	1	
252	81015252-00	中座	Feed plate set bracket		1
253	81015253-00	針板 (單針)	Needle plate	1	
254	81015254-00	針板 (1/16) 雙針	Needle plate(1/16)		1
255	81015255-00	螺絲	Screw(for Fig.253.254)	2	2
256	81015256-00	螺帽	Nut	1	1
257	81015257-00	蓋板	Cover plate	1	
258	81015258-00	蓋板 (下後)	Cover plate		1
259	81015259-00	蓋板 (下後)	Cover plate(lower)		1
260	81015260-00	彈墊片	Spring washer	6	8
261	81015261-00	螺絲	Screw(for Fig.252)	6	6
262	81015262-00	螺絲	Screw(for Fig.250)	2	2
262-1	81015262-01	墊片	Washer	1	1
263	81015263-00	螺絲	Screw(for Fig.250)	2	2
264	81015264-00	送料板滑塊	Square block	1	1
265	81015265-00	螺帽	Nut	1	1
266	81015266-00	彈簧華司	Spring washer	1	1
267	81015267-00	螺絲	Screw	1	1
268	81015268-00	螺絲	Screw	1	1
269	81015269-00	送料板	Feed plate	1	1
270	81015270-00	直角臺	Side cover plate bracket	1	1
271	81015271-00	螺絲	Screw(for Fig.270)	4	



梭頭機構部分

HOOK MECHANISM

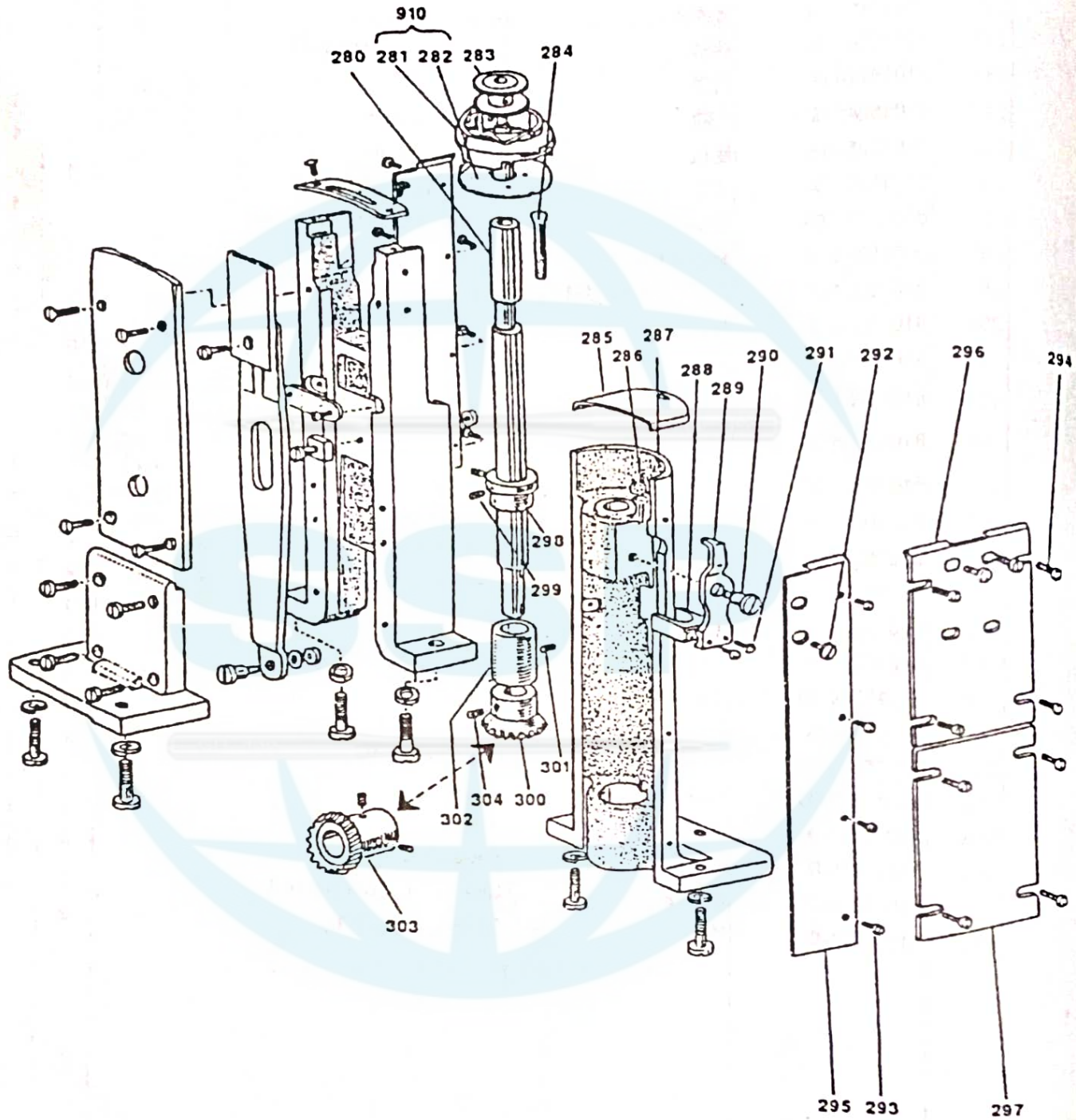

梭頭機構部份  
HOOKMECHANISM

個/台  
Amt.req

Fig No.	Part No. 零件號碼	部 品 名	Name of part	個/台	
				2000-5	2000-6
280	81017280-00	梭頭軸	Hook shaft	1	2
910	81017910-00	梭頭組	Hook Assy	1	2
281	81017281-00	梭頭	Hook	1	2
282	81017282-00	護針片	Noodle bracket	1	2
283	81017283-00	梭子	Bobin	1	2
284	81017284-00	螺絲	Screw(for Fig 280)	1	2
285	81017285-00	滑蓋	Slide plate	1	2
286	81017286-00	油墊	Felt	1	2
287	81017287-00	梭頭軸支座	Hook shaft supporter	1	2
288	81017288-00	牛角底座	Rotating hook opener bracket	1	2
289	81017289-00	牛角	Rotating hook opener	1	1
290	81017290-00	螺絲	Screw(for Fig.289)	1	2
291	81017291-00	螺絲	Screw(for Fig.289)	2	4
292	81017292-00	螺絲	Screw	1	2
293	81017293-00	螺絲	Screw(for Fig.295-297)	8	
294	81017294-00	螺絲	Screw(for Fig.295-297)		16
295	81017295-00	蓋板	Cover plate	1	
296	81017296-00	蓋板	Cover plate		1
297	81017297-00	蓋板	Cover plate		1
298	81017298-00	梭頭杆套環	Hook shaft collar	1	2
299	81017299-00	螺絲	Set screw(for Fig.298)	2	4
300	81017300-00	斜齒輪	Bevel gear	1	2
301	81017301-00	螺絲	Set screw(for Fig.302)	1	2
302	81017302-00	梭頭軸襯套	Hook shaft bushing	1	2
303	81017303-00	梭頭軸斜齒輪	Hook shaft bevel gear(lower)	1	2
304	81017304-00	螺絲	Set screw(for Fig.303)	4	8



給油機構部分

OIL LUBRICATION MECHANISM

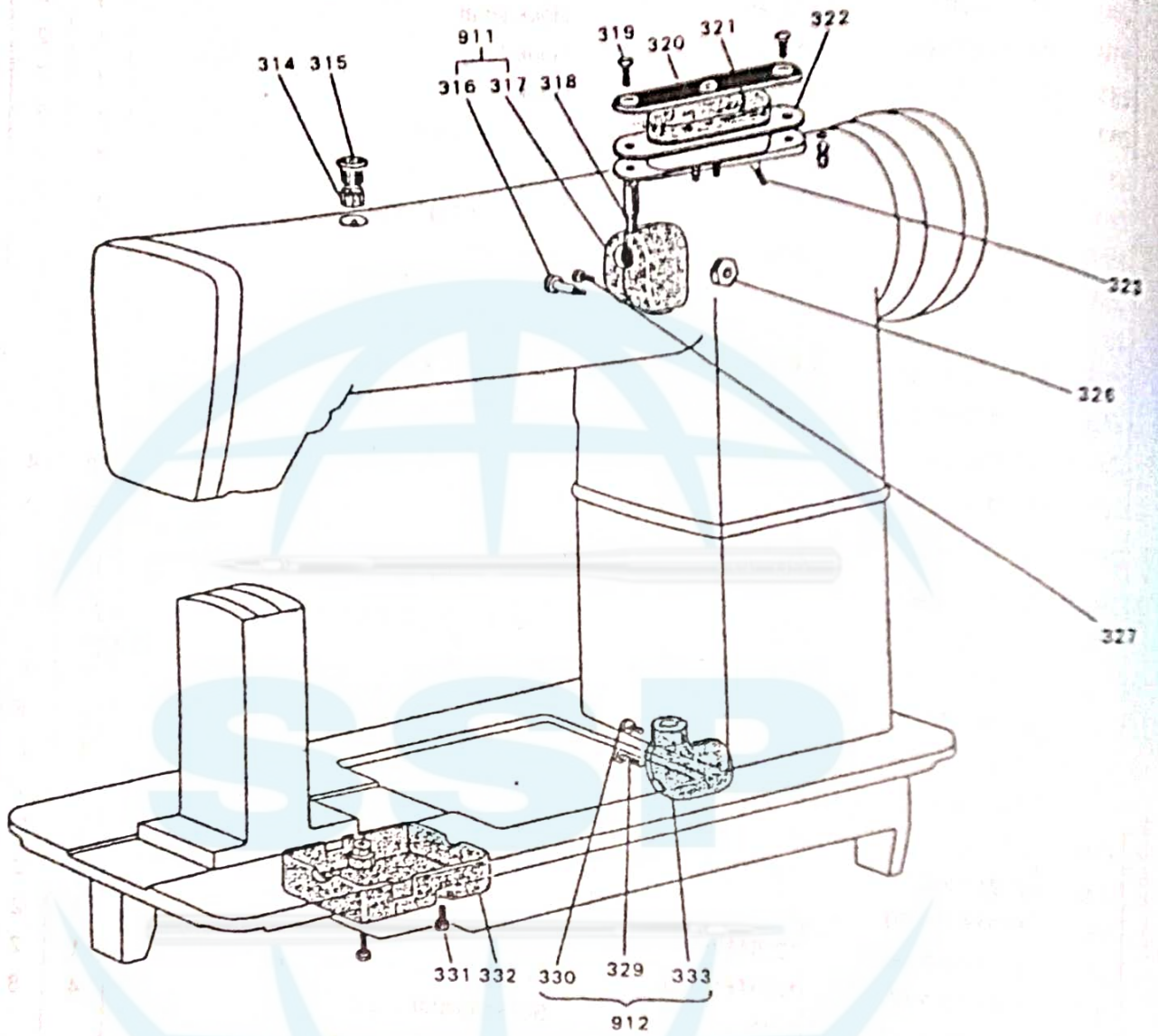

## 給油機構部份

## OIL LUBRICATION MECHANISM

個/台  
Amt.req

Fig. No.	Part No. 零件號碼	部 品 名	Name of part	個/台 Amt.req	
				2000-5	2000-6
314	81019314-00	油棉	Felt	1	1
315	81019315-00	油蓋 (左)	Oil cap(left)	1	1
911	81019911-00	齒輪箱 (上組)	Gear box(upper set)	1	1
316	81019316-00	螺絲	Screw(for gear box)	1	1
317	81019317-00	齒輪梢	Gear box	1	1
318	81019318-00	上齒箱梢	Gear box(upper)pin	1	1
319	81019319-00	螺絲	Screw(for Fig.320)	2	2
320	81019320-00	蓋板	Cover plate	1	1
321	81019321-00	油棉	Felt	1	1
322	81019322-00	油棉槽	Oil tank(right)	1	1
323	81019323-00	2.5 φ *150油棉心	Oil wick	2	2
326	81019326-00	螺絲	Screw	1	1
327	81019327-00	螺絲	Screw	1	1
912	81019912-00	齒輪箱 (下組)	Gear box(lower set)	1	1
329	81019329-00	螺絲	Screw	1	1
330	81019330-00	螺絲	Screw	1	1
331	81019331-00	螺絲	Screw(for Fig.332)	2	2
332	81019332-00	齒輪箱	gear box(lower)	1	1
333	81019333-00	齒輪箱	Gear box(lower set)	1	1



配件部分

GAUGE PARTS



600~604



617~619



606~607



620~622



605



609~612



608



614

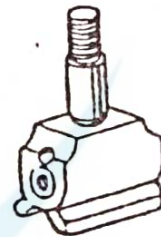

613



616

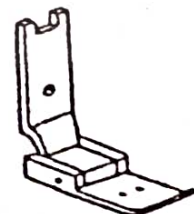

615

## GAUGE PARTS

Gauge Size

Fig. No.	Part No. 零件號碼	部 品 名	Name of part	Gauge Size					
				3/64	1/16	3/32	1/8	1/4	
				1	12	16	24	32	64
600	81021600-00	針板	Needle plate	1					
601	81021601-00	針板	Needle plate		1				
602	81025254-00	針板	Needle plate			1			
603	81021603-00	針板	Needle plate				1		
604	81021604-00	針板	Needle plate					1	
605	81021605-00	針板	Needle plate						1
606	81015249-00	狗齒	Feed dog	1	1	1	1		
607	81021607-00	狗齒	Feed dog					1	
608	81021608-00	狗齒	Feed dog						1
609	81021609-00	針樞	Needle clamp	1	1				
610	81021610-00	針樞	Needle clamp			1			
611	81021611-00	針樞	Needle clamp				1		
612	81021612-00	針樞	Needle clamp					1	
613	81021613-00	針樞	Needle clamp						1
614	81021614-00	押腳	Presser foot	1	1	1	1	1	
615	81021615-00	押腳	Presser foot						1
616	81021616-00	針檔	Needle guide	1	1	1			
617	81021617-00	針檔	Needle guide	1	1	1			
618	81021618-00	針檔	Needle guide				1		
619	81021619-00	針檔	Needle guide					1	
620	81021620-00	墊片0.6t	Washer	1	1			1	
621	81021621-00	墊片0.8t	Washer			1			
622	81021622-00	墊片1.2t	Washer				1	1	



附件部分

ACCESSORIES

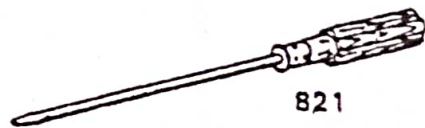
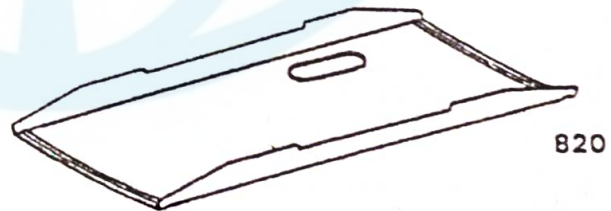
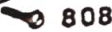
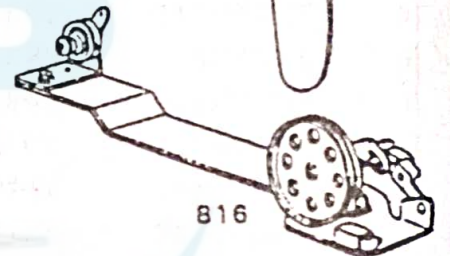
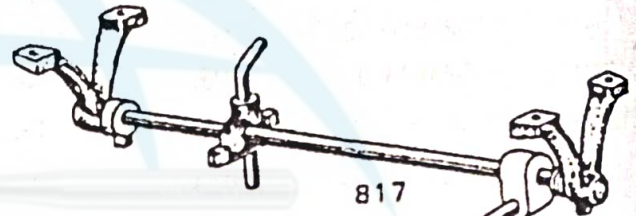
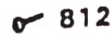
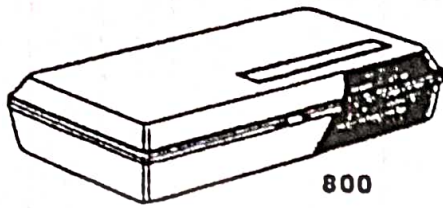

ACCESSORIES

Fig No.	Part No 零件號碼	部 品 名 Name of part	個 / 台 Amt.req	
			2000-5	2000-6
800	81023800-00	附件盒 Accessory box	1	1
801	81023801-00	橡膠墊 Vibration preventing rubbers	4	4
802	81023802-00	後鈕片 Hinge(2)	2	2
803	81023803-00	螺絲 Screw	4	4
804	81023804-00	油壺 Oil(large)	1	1
805	81023805-00	針#16 Needle	4	6
806	81023806-00	螺絲起子(小) Screw driver(small)	1	1
807	81023807-00	螺絲起子(中) Screw driver(middle)	1	1
808	81023808-00	後鈕螺絲 Screw	4	4
809	81023809-00	後鈕扣 Hinge(1)	2	2
810	81023810-00	壓墊 Bed presser	1	1
811	81023811-00	柱塞 Rubber plug	1	1
812	81023812-00	螺絲 Screw	2	2
813	81023813-00	華司 Washer	2	2
814	81023814-00	螺釘 Nail	8	8
815	81023815-00	梭子 Bobbin	4	6
816	81023816-00	卷線架 Bobbing winder	1	1
817	81023817-00	腳手組 Knee lifter	1	1
818	81023818-00	螺絲 Screw	1	1
819	81023819-00	車頭蓋 Vinyl cover	1	1
820	81023820-00	油盤 Oil reservoir	1	1
821	81023821-00	螺絲起子(大) Screw driver(large)	1	1



FOR 810.

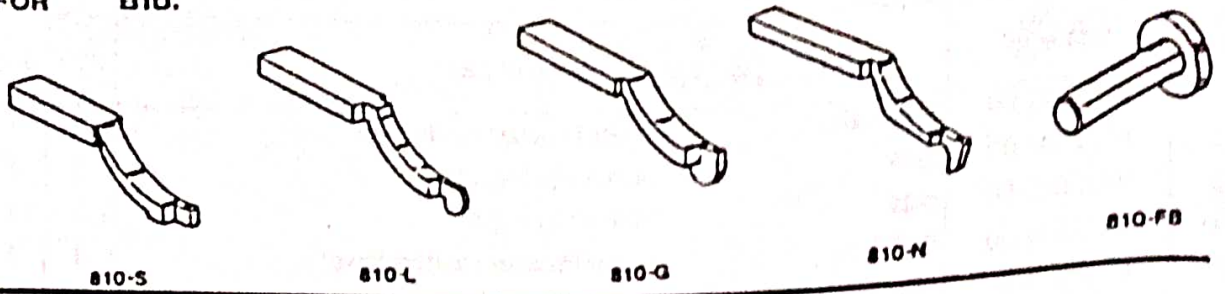

FOR 820.

